

1993

PRESQUE ISLE COUNTY
RECORDED

93 DEC 22 AM 10:02

COMM

LAND CORNER RECORDATION CERTIFICATE
Filing Requirement of Act 74, Mich. P.A. 1970

Janet M. Lamb
REGISTER OF DEEDS

For corners in

<u>PRESQUE ISLE</u> (County)	Located In:	Corner Code #
1. Public Land Survey	T <u>34</u> N R <u>2E</u>	<u>G-8</u>
	T _____ R _____	_____
	T _____ R _____	_____
	T _____ R _____	_____
2. Property Controlling in Section	S _____ T _____ R _____	_____
	S _____ T _____ R _____	_____
3. Miscellaneous Property in Sec.	S _____ T _____ R _____	_____
	S _____ T _____ R _____	_____

Register of Deeds Stamp & File Number

4. Lot No. _____, Recorded Plat _____
5. Private Claims _____

I, DELMER E. PORTER field survey on SEPT. 25, 1993, do hereby certify that under requirements of P.A. 74, Michigan P.A. of 1970, the corner points mentioned in lines 1 and 2 above were in conformance with regulations and rules therefore as required in the current manual of survey instructions of the United States Department of the Interior, Bureau of Land Management or by a decree of a Court of Law and/or that the corner points mentioned in lines 3, 4 and 5 above were in conformance with the rules of the Michigan Board of Land Surveyors or by a Decree of a Court of Law; established, re-established, monumented, re-monumented, recovered, found as expressed below:

A	B	C	D	E	F	G	H	I	J	K	L
2	6	5	4	3	2	1					
3											
4	7	8	9	10	11	12					
5											
6	18	17	16	15	14	13					
7											
8	19	20	21	22	23	24					
9											
10	30	29	28	27	26	25					
11											
12	31	32	33	34	35	36					
13											

NOTE: Not more than 4 corners, all in the same town and range, may be recorded on this certificate.

A. Description of original monument and accessories and/or subsequent restoration:

G-8 GLO NOTES
JULY 18, 1855
CEDAR 9" S 55° E 35 lks.
HEMLOCK 18" N 67° W 22lks.

WITNESSES
N 38° W 40.03' 7" BIRCH
S 86° W 25.66' 10" SPRUCE

G-8 P.A. 74 FILING BY DELMER E. PORTER
L.S. 15410 APRIL 20, 1976 PAGE 115
LAND CORNER RECORDS
SET 1/2" ROD & CAP #15410 BY SINGLE PROPORTION

B. Description of corner evidence found and/or method applied in restoring or reestablishing corner:

G-8
SEPT. 25, 1993
FOUND 1/2" ROD & CAP #15410
N 31° W 40.22' 10" BIRCH
S 88° W 25.72' 12" SPRUCE

Ratified by Peer Group
in accordance with P.A. 345
Chairman *Delmer E. Porter*
Date December 14, 1993

C. Description of monument for corner and accessories established to perpetuate locating the position of the corner:

G-8
1/2" ROD & CAP #15410
N 31° W 40.22' 10" SPRUCE
S 88° W 25.72' 12" SPRUCE
S 08° E 21.10' 6" ASPEN
S 80° E 20.76' 5" ASPEN

* NAILS AND TAGS #15410 USED IN WITNESS
PORTER'S SURVEY, P.C.

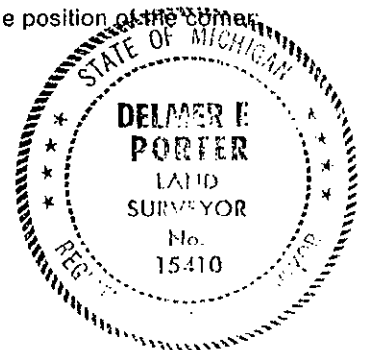

Signed by *Delmer E. Porter*
Surveyor's Michigan License No. 15410

Date Dec 20, 1993

CORNER HISTORY RESEARCH SHEET

G-8

T34N,R2E ALLIS TOWNSHIP-NORTH PART,
PRESQUE ISLE COUNTY, MICHIGAN.

ACTIVITY MONUMENT & ACCESSORIES - COMMENTS

GLO Survey July 18, 1855	Cedar 9" S55°E 35 Links Hemlock 13" W67°W 22 Links	
Act 74 filing by: Delmer E. Porter #15410, Apr. 20, 1976 Page 115, Corner Recordations	Fd. nothing in Gravel Road Set 1/2" Rod & Cap #15410 by Single Proportion N38°W 40.03' 7" Birch S86°W 25.66' 10" Spruce	
Act 132 Survey by: Delmer E. Porter #15410, May 15, 1976 Survey#38-76 File#34R2074	Same as above	
Act 132 Survey by: Delmer E. Porter #15410, Survey#41-91 File#34R2247	Same as above	
Remonumentation Sept. 25, 1993	Fd. 1.2" Rod & Cap#15410 N31°W 40.22' 10" Birch S88°W 25.72' 1;2" Spruce Left Same N31°W 40.22' 10" Birch S88°W 25.72' 12" Spruce S08°E 21.10' 6" Aspen S80°E 20.76' 5" Aspen	

JAN 22 2001

SECTION