

1997 PRESQUE ISLE COUNTY STATE OF MICHIGAN REMONUMENTATION

LAND CORNER RECORDATION CERTIFICATE  
Filing Requirement of Act 74, Mich. P.A. 1970

LIBER 325 PAGE 083

For corners in

Presque Isle

(County)

Located in:

Corner Code #

Belknap Twp.

1. Public Land Survey

T 34N R 5E H 9

T R  
T R  
T R

2. Property Controlling in Section

S T R  
S T R

3. Miscellaneous Property in Sec.

S T R  
S T R

PRESQUE ISLE COUNTY  
RECORDED

97 DEC 18 AM 9:55

*Janet M. Lamb*  
REGISTER OF DEEDS

Register of Deeds Stamp & File Number

4. Lot No. \_\_\_\_\_, Recorded Plat \_\_\_\_\_  
5. Private Claims \_\_\_\_\_

I, James A. Beck+, in a field survey on Oct. 30, 1997 do hereby state that under requirements of P.A. 74, Michigan P.A. of 1970, the corner points mentioned in lines 1 and 2 above were in conformance with regulations and rules therefore as required in the current manual of survey instructions of the United States Department of the Interior, Bureau of Land Management or by a decree of a Court of Law and /or that the corner points mentioned in lines 3, 4 and 5 above were in conformance with the rules of the Michigan Board of Land Surveyors or by a Decree of a Court of Law; established, re-established, monumented, recovered, found as expressed below:

NOTE: Not more than 2 corners, all in the same town and range, may be recorded on this certificate.

	A	B	C	D	E	F	G	H	I	J	K	L	M
1													
2	6	5						3		2			1
3													
4	7	8	9	10	11	12							
5													
6	16	17	18	19	20	21	22	23	24				
7													
8	19	20	21	22	23	24							
9								⊙					
10	30	29	28	27	26	25							
11													
12	31	32	33	34	35	36							
13													

A. Description of original monument and accessories and/or subsequent restoration:

H 9 Date: 1856 G.L.O. by Alfred Millerd  
"Set qr. Sec. post"  
Cedar 9 N58W 20  
Hemlock 14 S30E 29

SEE REVERSE SIDE OF CERTIFICATE  
FOR ADDITIONAL ACTIVITY AT CORNER

B. Description of corner evidence found and/or method applied in restoring or reestablishing corner:

H 9  
Found 1/2" iron rod and Delmer Porter R.L.S. 15410 cap and the following accessories:  
N 58°W 13.2 ft., old G.L.O bearing tree stump  
N 58°W 22.55 ft., 10" Maple  
N 11°W 4.59 ft., 14" Birch

SURVEY &  
REMONUMENTATION

JAN 14 1998

SECTION

C. Description of monument for corner and accessories established to perpetuate locating the position of the corner:

H 9 1/2" iron rod and Delmer Porter R.L.S. Cap  
Accessories:  
N 58°W 13.2 ft., old G.L.O bearing tree stump  
N 58°W 22.55 ft., 10" Maple  
N 11°W 4.59 ft., 14" Birch  
S 85°E 19.44 ft., 10" Cedar  
S 45°E 14.38 ft., 6" Cedar

Ratified by Peer Group  
in accordance with P.A. 345  
Chairman *Norman J. ...*  
Date 11/13/97

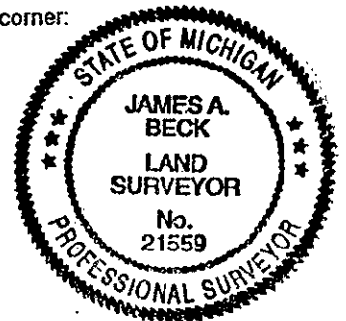

All witnesses have P.S. 21559 tags

Signed by James A. Beck  
Surveyor's Michigan License No. 21559

Date 12/8/1997

**PART "A" OF CERTIFICATE CONTINUED**

Date: Dec. 9, 1976 P.A. 132 Survey Certificate by Delmer E. Porter Reg. No. 15410 recorded Liber 215, Page 882  
 Monument " 1/2" Rod & Cap"

Accessories:

N 11°W 4.59' 14" Birch

N 58°W 13.2' OBT stump

N 58°W 22.55', 6" Maple

Date: Dec. 20, 1976 P.A. 74 (Land Corner Recordation Certificate) page 168 by Ronald Bischer Reg. No. 22428

Part A. "N58°W 20 Links 9" Cedar"

Part B. "Set 1/2" Rod from O.B.T. stump

N58°W 13.20 Cedar stump with foot blaze"

Part C. Monument "1/2" rod"

N 58°W 22.55' 6" Maple

N 11°W 4.59' 14" Birch

Date: January 4, 1980 P.A. 132 Survey by Delmer E. Porter Reg. No. 15410 Recorded in Liber 234, Page 450

Monument: " 1/2" Rod & Cap"

N11°W 4.59' 14" Birch

N 58°W 13.2' O.B.T. Stump

N58°W 22.55' 6" Maple

Date: March 3, 1986, P.A. 132 Surveys by James A. Beck Reg. No. 21559

Monument: " 1/2" iron rod"

N 58°W 22.55' 6" Maple

N11°W 4.59' 14" Birch

Date: May 22, 1986, P.A. 132 Survey by James A. Beck Reg. No. 21559

Monument (from field notes) 1/2" iron rod

" S 1/4 Cor. Sec. 22"

N 58°W 22.55' 6" Maple

N11°W 4.59' 14" Birch

N58°W 13.2' OLD BEARING TREE STUMP