

MICHIGAN  
DEPARTMENT OF CONSERVATION  
FORESTRY DIVISION

LAND CORNER RECORD

T. 21 N.R. 3 W

Roscommon COUNTY

DESCRIPTION OF CORNER 1/4 corner on South Side Section 33 on county line

CORNER MONUMENT Left 2" pipe in place

DATE MONUMENT PLACED AND WITNESSED Nov. 15, 1966

WITNESSES TO CORNER.....

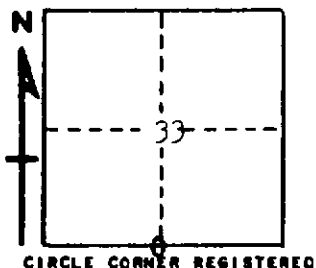

6" R. Pine N 24 W 45.2'

5" W. Pine N 40 E 49.5'

AND

DESCRIPTION IN DETAIL AS TO HOW CORNER WAS LOCATED AND IDENTIFIED OR RESTORED.

This corner was found during a survey of the county line. Found 2" pipe in place in center of road and in line with fireline north. Previously established by Marcus Schaaf, R.L.S.

SURVEYOR'S SEAL

SIGNED

*Kenneth J. Ostling*  
REGISTERED LAND SURVEYOR

DATE

Nov. 15, 1966

#10068