

MICHIGAN
DEPARTMENT OF CONSERVATION
FORESTRY DIVISION

LAND CORNER RECORD

T. 21 N.R. 3 W

Roscommon COUNTY

DESCRIPTION OF CORNER Sec. corner common to Sections 33-34

CORNER MONUMENT Left 1 1/4" pipe in place

DATE MONUMENT PLACED AND WITNESSED November 15, 1966

WITNESSES TO CORNER.....

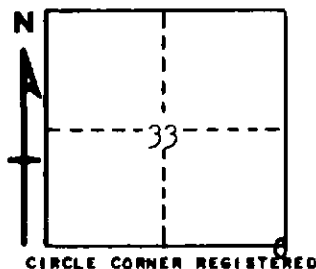

10" Oak N 41 W 43.3'

12" Oak N 54 E 47.2'

AND

DESCRIPTION IN DETAIL AS TO HOW CORNER WAS LOCATED AND IDENTIFIED OR RESTORED.

This corner was found during a survey of the county line. Found 1 1/4" pipe in place in center of E-W road, but about 12' west of fireline north. Probably established in a previous survey by Marcus Schaaf. No evidence to contrary, and considered acceptable as the corner.

SURVEYOR'S SEAL

SIGNED *Kenneth J. Ostberg* DATE Nov. 29, 1966
REGISTERED LAND SURVEYOR #10068