

SURVEY & REMONUMENTATION

MAY 28 1997

4732 COMMISSION

LAND CORNER RECORDATION CERTIFICATE Filing Requirement of Act 74, Mich. P.A. 1970

STATE OF MICHIGAN
ROSCOMMON COUNTY
RECORDED

11 JUL 96 11:29 A.M.

ROBERT W. SMITH
REGISTER OF DEEDS

**TO BE FILED IN LIBER 3 OF LAND CORNE
Register of Deeds Stamp & File Number**

For corners in <u>Roscommon</u> (County)	Located In:	Corner Code #
1. Public Land Survey	T <u>22N</u> R <u>2W</u>	<u>M - 9</u>
	T _____ R _____	_____
	T _____ R _____	_____
	T _____ R _____	_____
2. Property Controlling in Section	S _____ T _____ R _____	_____
	S _____ T _____ R _____	_____
3. Miscellaneous Property in Section	S _____ T _____ R _____	_____
	S _____ T _____ R _____	_____
4. Lot No. _____, Recorded Plat _____		
5. Private Claims _____		

	A	B	C	D	E	F	G	H	I	J	K	L	M
2	6		5		4		3		2		1		
3													
4	7		8		9		10		11		12		
5													
6	18		17		16		15		14		13		
7													
8	19		20		21		22		23		24		
9													
10	30		29		28		27		26		25		
11													
12	31		32		33		34		35		36		
13													

I, Marvin E. Myers, in a field survey on June 18, 1996, do hereby certify that under requirements of P.A. 74, Michigan P.A. of 1970, the corner points mentioned in lines 1 and 2 above were in conformance with regulations and rules therefore as required in the current manual of survey instructions of the United States Department of the Interior, Bureau of Land Management or by a decree of a Court of Law and/or that the corner points mentioned in lines 3, 4 and 5 above were in conformance with the rules of the Michigan Board of Professional Surveyors or by a Decree of a Court of Law; established, re-established, monumented, re-monumented, recovered, found as expressed below:

NOTE: Not more than 4 corners, all in the same town and range, may be recorded on this certificate.

A. Description of original monument and accessories and/or subsequent restoration:

GLO - Nov 1838 J. Brinks	L.332, P. 150 May 1977 Henning
Mon - Post	Mon - RR Spike
Wit - 10" Aspen S30°W 50 Lks	Wit - 14" B. Oak S35°W 64.2
16" Y. Pine N32°W 73 Lks	12" B. Oak N42°W 56.6
Old Field Notes(Date Unknown)	Conc. Mon. S30°E 68.4
(Possible Delamater)	L628, P. 383 Nov 11, 1992 F. J. Arleth
Mon - No Corner found, set 5/8" bar in intersection	Mon - RR Spike
Wit - Old BT 10" B. Oak N76°E 44.3	Wit - 14" B. Oak S35°W 64.2
Old BT 8" W. Oak S49°E 50.6	12" B. Oak N42°W 56.6
L. 2, P. 203	Conc. Mon S30°E 68.4
Mon - 5/8" Iron	
Wit - 10" B. Oak N76½°E 44.3	
8" W. Oak S49°E 50.6	

B. Description of corner evidence found and/or method applied in restoring or reestablishing corner:

Found RR spike in centerline road N-S and Trail road East
 Found concrete monument S23°E 68.40'
 Accepted RR spike as the best available evidence of the position of the original corner.
 Replaced RR spike with standard Roscommon County Monument.

**ROSCOMMON COUNTY
PEER GROUP APPROVAL
DATE June 17, 1996**

Marvin E. Myers
**Marvin E. Myers, P.S.
County Surveyor**

C. Description of monument for corner and accessories established to perpetuate locating the position of the corner:

Mon. - Set Standard Roscommon County Monument in pavement box
 WIT: Set nail SE side 14" W.Oak S50°W 59.00'
 Set nail S. side 14" B.Oak N84°W 43.66'
 Set nail NE side 8" J.Pine N22½°W 69.03'
 Set nail NW side 4" B.Oak N81°E 71.78'

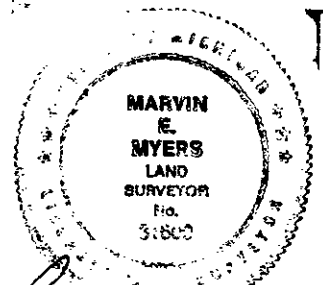

Signed by *Marvin E. Myers*

Date July 1, 1996

Surveyor's Michigan License No. 31600

1 - 2 Dues 3.05