

SURVEY & REMONUMENTATION

APR 24 1995

ROSCOMMON COUNTY
PEER GROUP APPROVAL
DATE Nov 29, 1994

MEMORANDUM

ROSCOMMON COUNTY REMONUMENTATION LAND CORNER RECORDATION CERTIFICATE

STATE OF MICHIGAN
ROSCOMMON COUNTY
RECORDED

Filing Requirement of Act 74, Mich. P.A. 1970

16 DEC 94 2:37 P.M.

ROBERT W. SMITH
REGISTER OF DEEDS

For corners in

Roscommon <small>(County)</small>	Located In:	Corner Code #
1. Public Land Survey	T 22N R 4W	H - 3
	T _____ R _____	_____
	T _____ R _____	_____
	T _____ R _____	_____
2. Property Controlling in Section	S _____ T _____ R _____	_____
	S _____ T _____ R _____	_____
3. Miscellaneous Property in Sec.	S _____ T _____ R _____	_____
	S _____ T _____ R _____	_____

TO BE FILED IN LIBER 3 OF LAND CORNER
Register of Deeds Stamp & File Number

4. Lot No. _____, Recorded Plat _____
5. Private Claims _____

	A	B	C	D	E	F	G	H	I	J	K	L	M
2	6	5	4	3	2	1							
3													
4	7	8	9	10	11	12							
5													
6	13	17	16	15	14	13							
7													
8	19	20	21	22	23	24							
9													
10	30	29	28	27	26	25							
11													
12	31	32	33	34	35	36							
13													

I, Marvin E. Myers, in a field survey on November 28, 19 94, do hereby certify that under requirements of P.A. 74, Michigan P.A. of 1970, the corner points mentioned in lines 1 and 2 above were in conformance with regulations and rules therefore as required in the current manual of survey instructions of the United States Department of the Interior, Bureau of Land Management or by a decree of a Court of Law and/or that the corner points mentioned in lines 3, 4 and 5 above were in conformance with the rules of the Michigan Board of Land Surveyors or by a Decree of a Court of Law; established, re-established, monumented, re-monumented, recovered, found as expressed below:

NOTE: Not more than 4 corners, all in the same town and range, may be recorded on this certificate.

A. Description of original monument and accessories and/or subsequent restoration:

GLO-Artemas Curtis Sept. 1852	L.2, pg.261	Cavanagh Sept. 1992
Mon-Post	WIT: 14" Tw.Maple S70°E 57.38	Mon-
WIT: 36" W.Pine N84°E 9 lks.	8" Maple N45°E 66.32'	WIT: Sp. in P.Pole N44°E 43.90'
10" Sugar S67°W 33 lks.		Sp. in P.Pole S48°E 43.55'
	Cavanagh Dec. 1977	Maple N26°W 50.40'
Plat of OTTAWA H.LLS	Mon-	5" Scotch Pine S44°W 50.05'
Mon-Conc. Mon.	WIT: 14" Tw.Maple S70°E 57.38'	
	8" Maple N45°E 66.32'	

B. Description of corner evidence found and/or method applied in restoring or reestablishing corner:

Monument- Found 1/2"x18" Bar & Brass Cap in Mon. Box 1.0' South of centerline of Knapp Road and 3.5'± East of centerline of Keneenaw Trail
WIT: Found spike in NE side of utility pole S39°E 43.63'
Found spike in NW side of utility pole N49°E 44.07'
Found spike East side of utility pole N33°W 47.45'
Accepted as the best available evidence of the position of the original corner.

C. Description of monument for corner and accessories established to perpetuate locating the position of the corner:

Mon-Std. Roscommon County Mon. stamped "T22N R4W H-3 31600" in mon. box
WIT: Fd. spike NE side utility pole S39°E 43.63'
Fd. spike NW side utility pole N49°E 44.07'
Fd. spike E. side utility pole N33°W 47.45'
Set wit. tag & nail SE side utility pole S44°W 45.21'

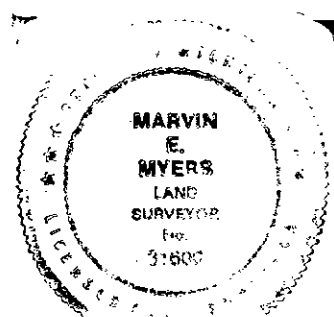

Signed by Marvin E. Myers Date Nov 29, 1994

Surveyor's Michigan License No. 31600

LIBER 3 PAGE 190