

# SURVEY & REMONUMENTATION

APR 24 1995

9198

ROSCOMMON COUNTY  
PEER GROUP APPROVAL  
DATE Nov 29, 1994

## COMMISSION

ROSCOMMON COUNTY REMONUMENTATION  
**LAND CORNER RECORDATION CERTIFICATE**  
Filing Requirement of Act 74, Mich. P.A. 1970

STATE OF MICHIGAN  
ROSCOMMON COUNTY  
RECORDED

For corners in

Roscommon <small>(County)</small>	Located in:	Corner Code #	
1. Public Land Survey	T <u>22N</u> R <u>4W</u>	<u>I - 2</u>	
	T _____ R _____	_____	
	T _____ R _____	_____	
	T _____ R _____	_____	
2. Property Controlling in Section	S _____ T _____ R _____	_____	
	S _____ T _____ R _____	_____	
3. Miscellaneous Property in Sec.	S _____ T _____ R _____	_____	
	S _____ T _____ R _____	_____	
4. Lot No. _____, Recorded Plat _____			
5. Private Claims _____			

16 DEC 94 2:37 P.M.

ROBERT W. SMITH  
REGISTER OF DEEDS

TO BE FILED IN LIBER 3 OF LAND CORNER  
Register of Deeds Stamp & File Number

I, Marvin E. Myers, in a field survey on November 11, 1994

do hereby certify that under requirements of P.A. 74, Michigan P.A. of 1970, the corner points mentioned in lines 1 and 2 above were in conformance with regulations and rules therefore as required in the current manual of survey instructions of the United States Department of the Interior, Bureau of Land Management or by a decree of a Court of Law and/or that the corner points mentioned in lines 3, 4 and 5 above were in conformance with the rules of the Michigan Board of Land Surveyors or by a Decree of a Court of Law; established, re-established, monumented, re-monumented, recovered, found as expressed below:

**NOTE: Not more than 4 corners, all in the same town and range, may be recorded on this certificate.**

**A. Description of original monument and accessories and/or subsequent restoration:**

GLO-Artemas Curtis  
Mon-Post  
WIT: 40" B.Oak N35°E 56 lks.  
10" Beech S85°W 31 lks.

G. Henning 4-4-45  
Mon-Iron Bolt in center  
of road  
WIT: None

MSHD Sept. 1958  
Mon-Fd. Boat Spike  
WIT: SE cor. Gas Station N55°W 58.90'  
SE cor. Store S39°W 73.65'  
Power Pole S66°E 34.07'

L.2, pg.254  
Mon-Fd. Boat Spike  
WIT: SE cor. Gas Station N55°W 58.90'  
SE cor. Store S39°W 73.65'  
Power Pole S66°E 34.07'

Cavanagh Oct. 1977  
Mon-Fd. Bolt in Pav't box  
WIT: SE cor. Garage N55°W 58.9'  
P.Pole S66°E 34.07'  
Boat Spike .7' North

Cavanagh April 1978  
Mon-Fd. Bolt in Pav't box  
WIT: SE cor. Garage N55°W 58.9'  
P.Pole S66°E 34.07'  
Boat Spike .7' North

Cavanagh Aug. 1978  
Mon-Iron in Pav't box  
WIT: SE cor. Gas Station N55°W 58.9'  
SE cor. Store S39°W 37.65'  
P.Pole S66°E

Cavanagh July 1985  
Mon-Fd. Bolt in Pav't box  
WIT: SE cor. Garage N55°W 58.9'  
P.Pole S66°E 34.07'  
Boat Spike .7' North

Cavanagh 6-11-87  
Mon-Iron in Pav't box  
WIT: SE cor. Gas Station N55°W 58.9'  
SE cor. Store S39°W 37.65'  
P.Pole S66°E 34.07'

Tim Lapham Mar. 1993  
(Act 74) L.1, pg.316  
Mon-3/4" Bar in Mon Box  
WIT: SW cor. Garage N35°E 77.75'  
SE cor. Garage N50°W 59.40'  
P.Pole S60°W 38.93'  
P.Pole S55°E 34.42'

**B. Description of corner evidence found and/or method applied in restoring or reestablishing corner:**

Monument-found 3/4" x 13" Iron Bar in Mon. Box centerline of Loxley Road and 2' South of centerline road to West  
WIT: Found MSHD Nail & Tag South side utility pole S64°E 34.46'  
Found Spike NW side utility pole S60°W 39.06'  
SE corner garage foundation N55°W 59.55'  
Accepted as the best available evidence of the position of the original corner.

**C. Description of monument for corner and accessories established to perpetuate locating the position of the corner:**

Mon-Set Std. Roscommon County Mon. stamped "T22N R4W I-2 31600" in mon. box  
WIT: Fd. Nail & Tag (MSHD) in S. side P.P. S64°E 34.46'  
SE cor. garage foundation N55°W 59.55'  
Fd. Spike NW side of P.P. S60°W 39.06'  
Set Nail NW side 8" Tw. Elm N53°E 63.08'  
Set Carsonite Post S64°E 33.65'

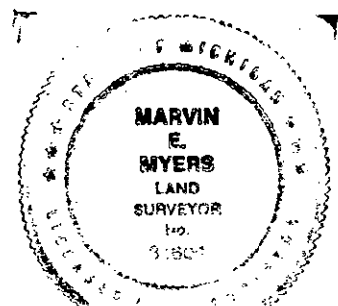

Signed by Marvin E. Myers  
Surveyor's Michigan License No. 31600

Date NOV 29, 1994