

SURVEY & REMONUMENTATION

APR 24 1995

ROSCOMMON COUNTY

PEER GROUP APPROVAL COMMISSION

**ROSCOMMON COUNTY REMONUMENTATION
LAND CORNER RECORDATION CERTIFICATE**

DATE Dec 6, 1994

Filing Requirement of Act 74, Mich. P.A. 1970

STATE OF MICHIGAN
ROSCOMMON COUNTY
RECORDED

For corners in

Roscommon (County)	Located In:	Corner Code #
1. Public Land Survey	T <u>22N</u> R <u>4W</u>	<u>L - 6</u>
	T _____ R _____	_____
	T _____ R _____	_____
	T _____ R _____	_____
2. Property Controlling in Section	S _____ T _____ R _____	_____
	S _____ T _____ R _____	_____
3. Miscellaneous Property in Sec.	S _____ T _____ R _____	_____
	S _____ T _____ R _____	_____
4. Lot No. _____, Recorded Plat _____		
5. Private Claims _____		

16 DEC 94 2:39 P.M.

ROBERT W. SMITH
REGISTER OF DEEDS

TO BE FILED IN LIBER 3 OF LAND CORNER
Register of Deeds Stamp & File Number

I, Marvin E. Myers, in a field survey on December 2, 19 94, do hereby certify that under requirements of P.A. 74, Michigan P.A. of 1970, the corner points mentioned in lines 1 and 2 above were in conformance with regulations and rules therefore as required in the current manual of survey instructions of the United States Department of the Interior, Bureau of Land Management or by a decree of a Court of Law and/or that the corner points mentioned in lines 3, 4 and 5 above were in conformance with the rules of the Michigan Board of Land Surveyors or by a Decree of a Court of Law; established, re-established, monumented, re-monumented, recovered, found as expressed below:

NOTE: Not more than 4 corners, all in the same town and range, may be recorded on this certificate.

A. Description of original monument and accessories and/or subsequent restoration:

George Henning July 1943
Mon-36" 'T' iron
WIT: 7" W.Oak N11°W 37.10' (B.T.)
5" B.Oak S28½°W 6.8'; (B.T.)

L.2, pg.264 LCRC
Mon-
WIT: 7" W.Oak N11°W 37.10'
5" B.Oak S28½°W 6.80'

G. Henning 6-22-1972 L.265, pg.137
Mon-Conc. Mon.
WIT: None

B. Description of corner evidence found and/or method applied in restoring or reestablishing corner:

Monument - Found ½" x 18" Bar & Cap 1.3' North of centerline Crestview
WIT: Fd. spike SE side 18" R.Oak N49°E 50.05'
fd. conc. mon. N05°E 33.03'
Fd. blaze S. face 24" W.Oak N06°W 36.54'
Fd. spike SW side 18" R.Oak N27½°W 40.80'
Fd. ½" Bar & Cap #17614 S05°W 32.90'
Fd. spike N. side 9" W.Oak S21°W 52.17'
fd. spike N. side 13" B.Oak S34½°E 58.51'
K-6 N83°49'58"W 2616.52'
M-6 S83°51'26"E 2621.71'
L-7 S04°06'41"W 2633.09'
Accepted as the best available evidence of the position of the original corner.

C. Description of monument for corner and accessories established to perpetuate locating the position of the corner:

Monument - Set std. Roscommon County Mon. stamped "T22N R4W L-6 31600" in Mon. Box
WIT: Fd. spike SE side 18" R.Oak N49°E 50.05'
Fd. Conc. Mon. N05°E 33.03'
Fd. blaze S. face 34" W.Oak N06°W 36.54'
Fd. spike SW side 18" R.Oak N27½°W 40.80'
Fd. ½" Bar & Cap #17614 S05°W 32.90'
Fd. spike NW side 9" W.Oak S21°W 52.17'
Fd. spike N side 13" B.Oak S24½°E 58.51'
K-6 N83°49'58"W 2616.52'
M-6 S83°51'26"E 2621.71'
L-7 S04°06'41"W 2633.09'

	A	B	C	D	E	F	G	H	I	J	K	L	M
2	6	5	4	3	2	1							
3													
4	7	8	9	10	11	12							
5	13	14	15	16	17	18							
6													
7													
8	19	20	21	22	23	24							
9													
10	30	29	28	27	26	25							
11													
12	31	32	33	34	35	36							
13													

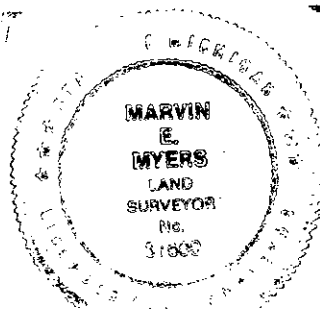

Signed by Marvin E. Myers

Date Dec 15, 1994

Surveyor's Michigan License No. 31600

LIBER 3 PAGE 100