

**SURVEY &
REMONUMENTATION**

APR 24 1995

**ROSCOMMON COUNTY
PEER GROUP APPROVAL**

DATE Dec 13, 1994

COMMISSION
ROSCOMMON COUNTY REMONUMENTATION
LAND CORNER RECORDATION CERTIFICATE
Filing Requirement of Act 74, Mich. P.A. 1970

STATE OF MICHIGAN
ROSCOMMON COUNTY
RECORDED

80908

For corners in

<u>Roscommon</u> (County)	Located In:	Corner Code #
1. Public Land Survey	T <u>22N</u> R <u>4W</u>	<u>M - 6</u>
	T _____ R _____	_____
	T _____ R _____	_____
	T _____ R _____	_____
2. Property Controlling in Section	S _____ T _____ R _____	_____
	S _____ T _____ R _____	_____
3. Miscellaneous Property in Sec.	S _____ T _____ R _____	_____
	S _____ T _____ R _____	_____
4. Lot No. _____, Recorded Plat _____		
5. Private Claims _____		

16 DEC 94 2:39 P.M.

ROBERT W. SMITH
REGISTER OF DEEDS

TO BE FILED IN LIBER 3 OF LAND CORNER
Register of Deeds Stamp & File Number

A	B	C	D	E	F	G	H	I	J	K	L	M
		5		4		3		2		1		
		8		9		10		11		12		
		13		17		16		15		14		13
		19		20		21		22		23		24
		30		29		28		27		26		25
		32		33		34		35		36		

I, Marvin E. Myers, in a field survey on December 13, 1994, do hereby certify that under requirements of P.A. 74, Michigan P.A. of 1970, the corner points mentioned in lines 1 and 2 above were in conformance with regulations and rules therefore as required in the current manual of survey instructions of the United States Department of the Interior, Bureau of Land Management or by a decree of a Court of Law and/or that the corner points mentioned in lines 3, 4 and 5 above were in conformance with the rules of the Michigan Board of Land Surveyors or by a Decree of a Court of Law; established, re-established, monumented, re-monumented, recovered, found as expressed below:

NOTE: Not more than 4 corners, all in the same town and range, may be recorded on this certificate.

A. Description of original monument and accessories and/or subsequent restoration:

- GLO-Artemas Curtis
Mon-Set Post
WIT: 18" Y.Pine S66°W 28 lks.
8" Birch N26°W 22 lks.
- G. Henning July 1943
Mon-1" Axel Shaft
WIT: P.Pole NW 57.2'
T.Pole NE 42.8'
P.Pole SE 40.7'
- R. Ostling Sept. 1948
Mon-Iron Shafting 8"
below surface
WIT: Spike in P.Pole S38½°E 28.1'
Spike in T.Pole N43°E 43.6'
Spike in T.Pole N37°W 52.5'
- MSHD 1958
Mon-1" Iron Bar
WIT: NE cor. stucco bldg. S41°W 91.47'
SE cor. stucco bldg. N39°W 107.64'
SE cor. stone house N20°E 103.75'
- MDOT R/W Plans
8.59' S. of C and
0.74' S. of L tangent
- R. Ostling July 24, 1959
Mon-Placed gear & shaft from
MSHD WIT.
WIT: Stucco bldg. S41°W 91.41'
10" Pine S58°E 84.94'
26" Poplar N26°E 76.35'

- L. Cavanagh July 17, 1975 L.307, pg.996
Mon-Axle Shaft in Mon. Box
WIT: None
- Cavanagh July 1978 L.355, pg.515
Mon-None
WIT: P.Pole NW 57.2'
T.Pole NE 42.8'
P.Pole SE 40.7'
- Cavanagh July 1978 L.1, pg.119 LCRC
Mon-None
WIT: P.Pole NW 57.2'
T.Pole NE 42.8'
P.Pole SE 40.7'

B. Description of corner evidence found and/or method applied in restoring or reestablishing corner:

Monument - Found 1" x 30" axle shaft & gear in Mon. Box in centerline Townline Road and 8'± S. of centerline M-55
WIT: Fd. blaze SW side 24" W.Pine S51°E 84.62'
Fd. spike SW side U.Pole N25°W 56.26'
Fd. spike N. side U.Pole S89°W 101.81'
Fd. SW cor. stone house N30°E 103.73'
Fd. spike SW side U.Pole S42½°E 41.96'
Accepted as the best available evidence of the position of the original corner.

C. Description of monument for corner and accessories established to perpetuate locating the position of the corner:

Mon-Set Std. Roscommon County Mon. stamped "T22N R4W M-6 31600" in mon. box in exact location of axel shaft
WIT: Fd. blaze SW side 24" W.Pine S51°E 84.62'
Fd. spike SW side U.Pole N25°W 56.26'
Fd. spike N. side U.Pole S89°W 101.81'
SW cor. stone house N30°E 103.73'
Fd. spike SW side U.Pole S42½°E 41.96'
Set wit. tag & nail SW side 24" W.Pine S51°E 84.62'

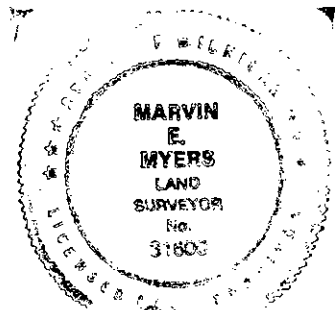

Signed by Marvin E. Myers
Surveyor's Michigan License No. 31600

Date Dec 15, 1994