

# SURVEY & REMONUMENTATION

APR 24 1995

**ROSCOMMON COUNTY  
PEER GROUP APPROVAL**  
DATE Dec 6, 1994

**COMMISSION**  
ROSCOMMON COUNTY REMONUMENTATION  
**LAND CORNER RECORDATION CERTIFICATE**  
Filing Requirement of Act 74, Mich. P.A. 1970

STATE OF MICHIGAN  
ROSCOMMON COUNTY  
RECORDED

919

For corners in

16 DEC 94 2:36 P.M.

ROBERT W. SMITH  
REGISTER OF DEEDS

| Roscommon<br>(County)                 | Located In:             | Corner Code # |
|---------------------------------------|-------------------------|---------------|
| 1. Public Land Survey                 | T 22N R 4W              | M - 7         |
|                                       | T _____ R _____         | _____         |
|                                       | T _____ R _____         | _____         |
|                                       | T _____ R _____         | _____         |
| 2. Property Controlling<br>in Section | S _____ T _____ R _____ | _____         |
|                                       | S _____ T _____ R _____ | _____         |
| 3. Miscellaneous<br>Property in Sec.  | S _____ T _____ R _____ | _____         |
|                                       | S _____ T _____ R _____ | _____         |
| 4. Lot No. _____, Recorded Plat _____ |                         |               |
| 5. Private Claims _____               |                         |               |

TO BE FILED IN LIBER 3 OF LAND CORNER  
Register of Deeds Stamp & File Number

I, Marvin E. Myers, in a field survey on November 23, 1994, do hereby certify that under requirements of P.A. 74, Michigan P.A. of 1970, the corner points mentioned in lines 1 and 2 above were in conformance with regulations and rules therefore as required in the current manual of survey instructions of the United States Department of the Interior, Bureau of Land Management or by a decree of a Court of Law and/or that the corner points mentioned in lines 3, 4 and 5 above were in conformance with the rules of the Michigan Board of Land Surveyors or by a Decree of a Court of Law; established, re-established, monumented, re-monumented, recovered, found as expressed below:

**NOTE: Not more than 4 corners, all in the same town and range, may be recorded on this certificate.**

**A. Description of original monument and accessories and/or subsequent restoration:**

|   |   |   |
|---|---|---|
| <p>GLO-Artemas Curtis Sept. 1852<br/>Mon-20" Y.Pine<br/>WIT: None</p> <p>MSHD Sept. 1958<br/>Mon-3/4" Iron Pipe<br/>WIT: 16" Oak S55°E 49.30'<br/>18" Oak N60°E 71.55'<br/>14" Box Elder S25°E 77.80'</p> <p>L.2, pg.234 LCRC<br/>Mon-3/4" Pipe<br/>WIT: 16" Oak S55°E 49.30'<br/>18" Oak N60°E 71.55'<br/>14" Box Elder S25°E 77.80'</p> | <p>L.2, pg.275 LCRC<br/>Mon-Fd. 1/2" Bar<br/>WIT: P.P. S45°W 44.70'<br/>16" B.Oak S70°E 49.00'<br/>24" B.Oak N70°E 70.00'</p> <p>Cavanagh Feb. 1973 L.272, pg.271<br/>Mon-Fd. 1/2" Bar<br/>WIT: None</p> <p>Cavanagh Mar. 1973 L.1, pg.78 LCRC<br/>Mon-Fd. 1/2" Bar<br/>WIT: P.P. S45°W 44.70'<br/>16" B.Oak S70°E 49.00'<br/>24" B.Oak N70°E 70.00'</p> <p>L.Cavanagh Apr. 25, 1975 L.303, pg.132<br/>Mon-Fd. 1/2" Bar<br/>WIT: None</p> | <p>Cavanagh Apr. 1977 L.331, pg.447<br/>Mon-1/2" Bar<br/>WIT: 16" B.Oak S70°E 49.00'<br/>24" B.Oak N70°E 70.00'<br/>P.P. S45°W 44.70'</p> <p>Cavanagh Oct. 1978 L.357, pg. 184<br/>Mon-Fd. 1/2" Steel Bar<br/>WIT: P.P. S45°W 44.70'<br/>16" B.Oak S70°E 49.00'<br/>24" B.Oak N70°E 70.00'</p> <p>Cavanagh Aug. 1987<br/>Mon-None<br/>WIT: P.P. S45°W 44.70'<br/>16" B.Oak S70°E 49.00'<br/>24" B.Oak N70°E 70.00'</p> <p>Cavanagh Mar. 1993<br/>Mon-1/2" Bar in Pav't Box<br/>WIT: P.P. S45°W 44.70'<br/>16" B.Oak S70°E 49.00'<br/>24" B.Oak N70°E 70.00'</p> |
|---|---|---|

**B. Description of corner evidence found and/or method applied in restoring or reestablishing corner:**

Monument - Found 1/2" x 17" Bar alongside 1/2" x 8" Bar over 3/4" Iron Pipe in Mon. Box in centerline Townline Road and centerline Nestle Road  
WIT: Fd. nail in P.P. S40°W 46.92'  
Fd. nail in P.P. N43°W 47.33'  
Fd. nail in P.P. S40°E 38.61'  
Fd. wit. tag "Roscommon County Reference" in 28" W.Oak S57°E 48.99'  
Accepted as the best available evidence of the position of the original corner.

**C. Description of monument for corner and accessories established to perpetuate locating the position of the corner:**

Mon-Set Std. Roscommon County Mon. stamped "T22N R4W M-7 31600" in Mon. Box over 3/4" Iron Pipe  
WIT: Fd. nail in P.P. S40°W 46.92'  
Fd. nail in P.P. N43°W 47.33'  
Fd. wit. tag (Roscommon County Reference) in 28" W.Oak S57°E 48.99'  
Set nail NW face 10" W.Oak N65°E 44.05'

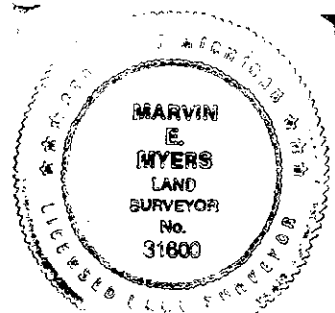

Signed by Marvin E. Myers Date Dec 15, 1994  
Surveyor's Michigan License No. 31600