

APR 24 1995

**LAND CORNER RECORDATION CERTIFICATE**  
COMMISSIONING Requirement of Act 74, Mich. P.A. 1970

STATE OF MICHIGAN  
ROSCOMMON COUNTY  
RECORDED

For corners in

ROSCOMMON (County)	Located In:	Corner Code #/
1. Public Land Survey	T 23N, R 3W	B-7
	T _____ R _____	_____
	T _____ R _____	_____
	T _____ R _____	_____
2. Property Controlling in Section	S _____ T _____ R _____	_____
	S _____ T _____ R _____	_____
3. Miscellaneous Property in Sec.	S _____ T _____ R _____	_____
	S _____ T _____ R _____	_____

22 NOV 94 11:08 A.M.

ROBERT W. SMITH  
REGISTER OF DEEDS  
**ROSCOMMON COUNTY**  
**PEER GROUP APPROVAL**  
DATE 10-20-94  
Register of Deeds Stamp & File Number

4. Lot No. \_\_\_\_\_, Recorded Plat \_\_\_\_\_  
5. Private Claims \_\_\_\_\_

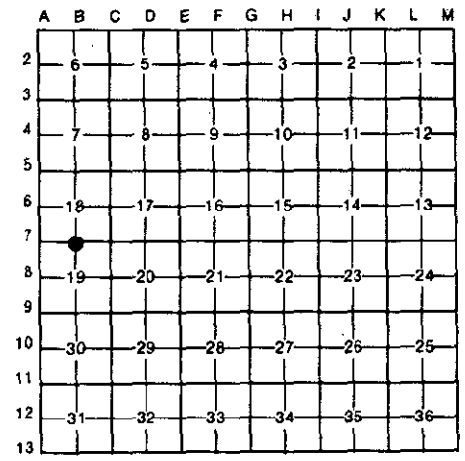

I, Marvin E. Myers, in a field survey on October 18, 19 94, do hereby certify that under requirements of P.A. 74, Michigan P.A. of 1970, the corner points mentioned in lines 1 and 2 above were in conformance with regulations and rules therefore as required in the current manual of survey instructions of the United States Department of the Interior, Bureau of Land Management or by a decree of a Court of Law and/or that the corner points mentioned in lines 3, 4 and 5 above were in conformance with the rules of the Michigan Board of Land Surveyors or by a Decree of a Court of Law; established, re-established, monumented, re-monumented, recovered, found as expressed below:

**NOTE: Not more than 4 corners, all in the same town and range, may be recorded on this certificate.**

A. Description of original monument and accessories and/or subsequent restoration:  
GLO-Artemas Curtis (1852)  
Mon-Post  
Wit- 8" W. Ash N30°W 30 lks  
10" Cedar S40°E 12 lks  
L2 P 377 LCRC  
Mon-Conc. Mon.  
Wit-8" Maple N45°E 16.81  
12" Maple S24°E 7.70

B. Description of corner evidence found and/or method applied in restoring or reestablishing corner:  
Found Concrete Monument at intersection of Fence lines North and West with 2"x14" wood stake alongside.  
Found 12" Maple with blaze N51°E 16.70  
Found 15" Maple with blaze S31°30'E 7.55  
Accepted as the best available evidence of the position of the original corner.

C. Description of monument for corner and accessories established to perpetuate locating the position of the corner:  
Mon-Set Std. Roscommon County Monument stamped" T23N, R3W, B-7, 31600" at exact location of Concrete Monument.  
Wit- Set Roscommon County Witness tag & nail in NW side 12" Maple(with blaze) N51°E 17.22  
Set Roscommon County Witness tag & nail in NE side 15" Maple(with blaze) S31°30'E 7.71  
Set Roscommon County Witness tag & nail in N side 7" Maple S68°W 40.48  
Set Roscommon County Witness tag & nail in SW side 12" Elm N38°W 13.47  
Set Carsonite Post East 2.8

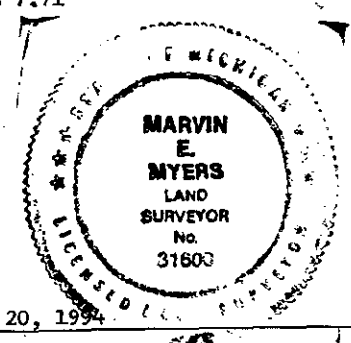

Signed by Marvin E. Myers Date October 20, 1994  
Surveyor's Michigan License No. 31600