

**SURVEY &
REMONUMENTATION**

**ROSCOMMON COUNTY
PEER GROUP APPROVAL
DATE _____**

APR 24 1995
LAND CORNER RECORDATION CERTIFICATE
Filing Requirements of Act 74, Mich. P.A. 1970

STATE OF MICHIGAN
ROSCOMMON COUNTY
RECORDED

For corners in

| | | |
|---------------------------------------|-------------------------|----------------|
| <u>ROSCOMMON</u> (County) | Located In: | Corner Code =# |
| 1. Public Land Survey | T 23N R 3W | G-11 |
| | T _____ R _____ | _____ |
| | T _____ R _____ | _____ |
| | T _____ R _____ | _____ |
| 2. Property Controlling in Section | S _____ T _____ R _____ | _____ |
| | S _____ T _____ R _____ | _____ |
| 3. Miscellaneous Property in Sec. | S _____ T _____ R _____ | _____ |
| | S _____ T _____ R _____ | _____ |
| 4. Lot No. _____, Recorded Plat _____ | | |
| 5. Private Claims _____ | | |

22 NOV 94 11:09 A.M.

ROBERT W. SMITH
REGISTER OF DEEDS
ROSCOMMON COUNTY
PEER GROUP APPROVAL
DATE 10-20-94 *MEM*

Register of Deeds Stamp & File Number

| | | | | | | | | | | | | | |
|----|----|----|----|----|----|----|---|---|---|---|---|---|---|
| | A | B | C | D | E | F | G | H | I | J | K | L | M |
| 2 | 6 | 5 | 4 | 3 | 2 | | | | | | | | |
| 3 | | | | | | | | | | | | | |
| 4 | 7 | 8 | 9 | 10 | 11 | 12 | | | | | | | |
| 5 | | | | | | | | | | | | | |
| 6 | 16 | 17 | 16 | 15 | 14 | 13 | | | | | | | |
| 7 | | | | | | | | | | | | | |
| 8 | 19 | 20 | 21 | 22 | 23 | 24 | | | | | | | |
| 9 | | | | | | | | | | | | | |
| 10 | 30 | 29 | 28 | 27 | 26 | 25 | | | | | | | |
| 11 | | | | | | | | | | | | | |
| 12 | 31 | 32 | 33 | 34 | 35 | 36 | | | | | | | |
| 13 | | | | | | | | | | | | | |

I, Marvin E. Myers, in a field survey on October 13, 19 94
do hereby certify that under requirements of P.A. 74, Michigan P.A. of 1970, the corner points mentioned in lines 1 and 2 above were in conformance with regulations and rules therof as required in the current manual of survey instructions of the United States Department of the Interior, Bureau of Land Management or by a decree of a Court of Law and/or that the corner points mentioned in lines 3, 4 and 5 above were in conformance with the rules of the Michigan Board of Land Surveyors or by a Decree of a Court of Law; established, re-established, monumented, re-monumented, recovered, found as expressed below:

NOTE: Not more than 4 corners, all in the same town and range, may be recorded on this certificate.

- A. Description of original monument and accessories and/or subsequent restoration:
- | | | |
|-------------------------------------|------------------------------|------------------------------|
| GLO-Artemas Curtis 1852 | L 2 P 392 & 393 LCRC | October 10, 1976 L.Cavanagh |
| MON- Set post | Mon- Conc. Mon. | Mon- Found 1/2" bar |
| Wit- 12" Maple N56°W 14 lks | Wit- 8" Maple N08°E 31.8 | Wit- 4" Y. Pine S63°W 46.2 |
| 10" B. Oak S45°E 4 lks | 6" Maple N79°W 24.6 | 36" W. Pine Stump N47°W 28.4 |
| Sept 1945 G. Henning | August 1, 1968 Ostling | July 10, 1980 Harold Oliver |
| Mon- Found 1/2"x30" bar in Original | Mon- 1/2" Steel bar | Mon- Found 1" Iron |
| U.S. Section Corner. | Wit- None given | Wit- none given |
| Wit- 45" W. Pine Stump S55°E 41.3 | July 30, 1980 L Cavanagh | Mon- None given |
| 36" W. Pine Stump S8°W 38.2 | June 26, 1972 G.E. Ostling | Wit- 5" Maple S36°E 25.17 |
| 4" Y. Pine S63°W 46.2 | Mon- Found 1/2" bar | 3" Maple S80°W 25.9 |
| April 4, 1956 R.T. Ostling | Wit- 4" Y pine S63°W 46.2 | 2" Maple S40°W 14.92 |
| Mon- 1/2" Bar in Corner | 36" W. Pine Stump N47°W 28.4 | 3" Maple N30°W 2.57 |
| Wit- None given | | |

3. Description of corner evidence found and/or method applied in restoring or reestablishing corner:
Found 1/2" bar at North face of Wood fence Post verified position by measurement to accessories of record And is accepted as a perpetuation of the original Government corner.

- C. Description of monument for corner and accessories established to perpetuate locating the position of the corner:
Mon- Set Std. Roscommon County Monument stamped " T23N, R3W, 31600, G-11" at North face of Fence Post in exact position of 1/2" bar.
Wit- Set-Roscommon County witness tag & nail NW side 7" R. Oak N60°E 16.52
Found Spike NE side 5" Maple N24°W 2.67
Found Spike SW side 8" Maple S30°E 25.41
Found Spike SE side 3" Maple S47°W 14.90
Found Spike S. side 7" Maple S85°W 25.95
Set Carsonite Post N05°E 5.0

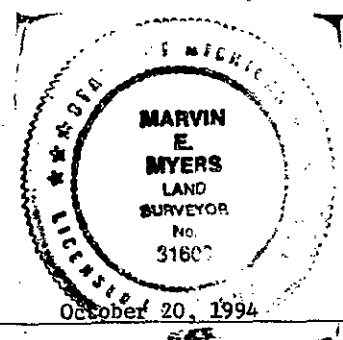

Signed by Marvin E. Myers Date _____

Surveyor's Michigan License No. 31600

LIBER 3 PAGE 175