

SURVEY & REMONUMENTATION

ROSCOMMON COUNTY REMONUMENTATION

APR 24 1995

LAND CORNER RECORDATION CERTIFICATE

Filing Requirement of Act 74, Mich. P.A. 1970

STATE OF MICHIGAN
ROSCOMMON COUNTY
RECORDED

For corners in **COMMISSION**

Roscommon <small>(County)</small>	Located In:	Corner Code #/	
1. Public Land Survey	T <u>23</u> R <u>3</u> W	<u>I -12</u>	
	T _____ R _____	_____	
	T _____ R _____	_____	
	T _____ R _____	_____	
2. Property Controlling in Section	S _____ T _____ R _____	_____	
	S _____ T _____ R _____	_____	
3. Miscellaneous Property in Sec.	S _____ T _____ R _____	_____	
	S _____ T _____ R _____	_____	
4. Lot No. _____, Recorded Plat _____			
5. Private Claims _____			

15 NOV 94 9:13 A.M.

ROBERT W. SMITH
REGISTER OF DEEDS

TO BE FILED IN LIBER 3 OF LAND CORNER

Register of Deeds Stamp & File Number

I, Frank J. Arleth, in a field survey on November, 1994, do hereby certify that under requirements of P.A. 74, Michigan P.A. of 1970, the corner points mentioned in lines 1 and 2 above were in conformance with regulations and rules therefore as required in the current manual of survey instructions of the United States Department of the Interior, Bureau of Land Management or by a decree of a Court of Law and/or that the corner points mentioned in lines 3, 4 and 5 above were in conformance with the rules of the Michigan Board of Land Surveyors or by a Decree of a Court of Law; established, re-established, monumented, re-monumented, recovered, found as expressed below:

NOTE: Not more than 4 corners, all in the same town and range, may be recorded on this certificate.

	A	B	C	D	E	F	G	H	I	J	K	L	M
2	6	5	4	3	2	1							
3													
4	7	8	9	10	11	12							
5													
6	18	17	16	15	14	13							
7													
8	19	20	21	22	23	24							
9													
10	30	29	28	27	26	25							
11													
12	31	32	33	34	35	36							
13													

A. Description of original monument and accessories and/or subsequent restoration:

Artemas Curtis Set Post 1852	1964 Ostling replaces 3/4" x 24" pine with concrete monument for Plat of Woodland Acres No.2, L.5 P. 33
W. Pine 15 N25°E 4 lks	Wit: 6" Maple S55°E 15.25
Hemlock 15 S45°W 23 lks	4" Birch N55°E 14.03
1941 Henning set 3/4" x 24" pipe at corner location during section subdivision of section 34.	10" Maple S25°W 36.6
Wit: 16" W. Oak N38°W 76.4	
14" Aspen S83°30'E 67.3	

B. Description of corner evidence found and/or method applied in restoring or reestablishing corner:

Nov. 1994 Arleth Found concrete monument set by Ostling for E 1/4 corner of Section 34.	Found 1/2" bar N2°02'20"W 13.10' for corner of lots 56 & 57, also found 1/2" bar S2°02'20"E 46.90' for corner of lots 55 & 56, Plat of Woodland Acres No.2
Found Old Wit: trees now	
12" Maple S55°E 15.0 + or -	
6" Birch N55°E 14.0 + or -	
16" Maple S25°W 36.0 + or -	

C. Description of monument for corner and accessories established to perpetuate locating the position of the corner:

Used Concrete monument in place with cap # 21266

N & T 12" group of Maples S23°E 59.95

N & T 14" Maple S55°E 50.93

N & T 8" Maple N87°E 41.18

N & T 14" Maple N 7°E 47.80

N & T 10" Maple N72°W 24.05

Set carsonite post at corner

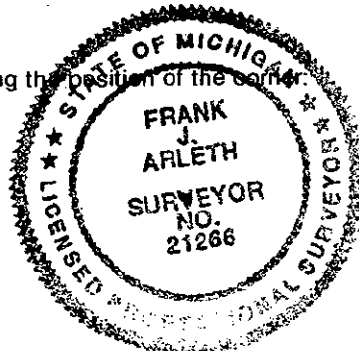

Signed by Frank J. Arleth Date 11/11/94

Surveyor's Michigan License No. 21266 P.S.

DATE 11/10/94 Peer Group Approved

LIBER 3 PAGE 152