

8283

SURVEY & REMONUMENTATION

ROSCOMMON COUNTY
PEER GROUP APPROVAL
DATE _____

APR 24 1995

LAND CORNER RECORDATION CERTIFICATE
COMMISSION
Filing Requirement of Act 74, Mich. P.A. 1970

STATE OF MICHIGAN
ROSCOMMON COUNTY
RECORDED

For corners in

Roscommon (County)	Located In:	Corner Code #
1. Public Land Survey	T 23N R 4W	E - 6
	T _____ R _____	_____
	T _____ R _____	_____
	T _____ R _____	_____
2. Property Controlling in Section	S _____ T _____ R _____	_____
	S _____ T _____ R _____	_____
3. Miscellaneous Property in Sec.	S _____ T _____ R _____	_____
	S _____ T _____ R _____	_____

10 NOV 94 3:27 P.M.

ROBERT W. SMITH
REGISTER OF DEEDS

ROSCOMMON COUNTY
PEER GROUP APPROVAL

DATE 9-15-94

Register of Deeds Stamp & File Number

- 4. Lot No. _____ Recorded Plat _____
- 5. Private Claims _____

I, Marvin E. Myers, in a field survey on September 8, 19 94, do hereby certify that under requirements of P.A. 74, Michigan P.A. of 1970, the corner points mentioned in lines 1 and 2 above were in conformance with regulations and rules therefore as required in the current manual of survey instructions of the United States Department of the Interior, Bureau of Land Management or by a decree of a Court of Law and/or that the corner points mentioned in lines 3, 4 and 5 above were in conformance with the rules of the Michigan Board of Land Surveyors or by a Decree of a Court of Law; established, re-established, monumented, re-monumented, recovered, found as expressed below:

	A	B	C	D	E	F	G	H	I	J	K	L	M
2	6	5	4	3	2	1							
3													
4	7	8	9	10	11	12							
5													
6	18	17	16	15	14	13							
7													
8	19	20	21	22	23	24							
9													
10	30	29	28	27	26	25							
11													
12	31	32	33	34	35	36							
13													

NOTE: Not more than 4 corners, all in the same town and range, may be recorded on this certificate.

A. Description of original monument and accessories and/or subsequent restoration:

GLO-Artemas Curtis 1852
Mon-Post
WIT: 6" Tamarack N65°W 29 lks.
5" Tamarack S47°E 26 lks.

B. Description of corner evidence found and/or method applied in restoring or reestablishing corner:

Found Monument 2"x11" Well Point laying on side 1 foot East of centerline of North-South Road. Accepted as the best available evidence of the position of the original corner.

C. Description of monument for corner and accessories established to perpetuate locating the position of the corner:

Mon-Set Std. Roscommon County Mon. stamped "E-6 T23N R4W 31600" 1' East of C N-S Road
WIT: Set Wit. Tag & Nail NE side of 10" J.Pine N18°W 71.82'
Set Wit. Tag & Nail NE side of 4" Elm S54°E 34.56'
Set Wit. Tag & Nail N. side of 13" J.Pine S82°W 30.49'
Set Wit. Tag & Nail SE side of 14" J.Pine S35°W 60.66'
Set Carsonite Post East 25.00'
E-5 N01°16'49"E 2647.72'
E-7 S01°16'49"W 2657.63'

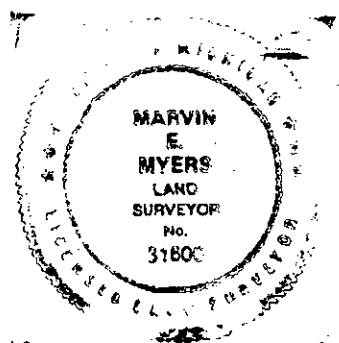

Signed by Marvin E. Myers

Date OCT 11, 1994

Surveyor's Michigan License No. 31600

FORM APPROVED BY MICHIGAN STATE BOARD OF LAND SURVEYORS, JAN. 28, 1971
REVISED MAY 14, 1975
REVISED JAN., 1983

LIBER 3 PAGE 105