

# SURVEY & REMONUMENTATION

APR 24 1995

**ROSCOMMON COUNTY**

**PEER GROUP APPROVAL COMMISSION**

**DATE** Dec 13, 1994

ROSCOMMON COUNTY REMONUMENTATION  
**LAND CORNER RECORDATION CERTIFICATE**  
Filing Requirement of Act 74, Mich. P.A. 1970

STATE OF MICHIGAN  
ROSCOMMON COUNTY  
RECORDED

16191

For corners in

16 DEC 94 2:35 P.M.

ROBERT W. SMITH  
REGISTER OF DEEDS

Roscommon <small>(County)</small>	Located In:	Corner Code #	
1. Public Land Survey	T <u>23N</u> R <u>4W</u>	<u>E - 7</u>	
	T _____ R _____	_____	
	T _____ R _____	_____	
	T _____ R _____	_____	
2. Property Controlling in Section	S _____ T _____ R _____	_____	
	S _____ T _____ R _____	_____	
3. Miscellaneous Property in Sec.	S _____ T _____ R _____	_____	
	S _____ T _____ R _____	_____	

TO BE FILED IN LIBER 3 OF LAND CORNER  
Register of Deeds Stamp & File Number

4. Lot No. \_\_\_\_\_, Recorded Plat \_\_\_\_\_  
5. Private Claims \_\_\_\_\_

	A	B	C	D	E	F	G	H	I	J	K	L	M
2	6	5	4	3	2	1							
3													
4	7	8	9	10	11	12							
5													
6	18	17	16	15	14	13							
7													
8	19	20	21	22	23	24							
9													
10	30	29	28	27	26	25							
11													
12	31	32	33	34	35	36							
13													

I, Marvin E. Myers, in a field survey on December 12, 1994, do hereby certify that under requirements of P.A. 74, Michigan P.A. of 1970, the corner points mentioned in lines 1 and 2 above were in conformance with regulations and rules therefore as required in the current manual of survey instructions of the United States Department of the Interior, Bureau of Land Management or by a decree of a Court of Law and/or that the corner points mentioned in lines 3, 4 and 5 above were in conformance with the rules of the Michigan Board of Land Surveyors or by a Decree of a Court of Law; established, re-established, monumented, re-monumented, recovered, found as expressed below:

**NOTE: Not more than 4 corners, all in the same town and range, may be recorded on this certificate.**

**A. Description of original monument and accessories and/or subsequent restoration:**

GLO-Artemas Curtis 1852	R.C.R.C. L.2, pg.412	Unknown
MON-Set Post	LCRC	Mon-Unknown
WIT: 12" Maple N17°W 17 lks.	Mon-½" Pipe	WIT: N89°15'30"E 2625.56' to F-7
14" W.Pine S40°E 27 lks.	WIT: 8" Poplar S84°E 39.63'	S00°17'30"E 2624.94' to E-8
	12" Poplar N38°W 61.41'	
	9" Birch S70°W 88.44'	
MSHD Aug. 5, 1960		
Plan & Profile		
Mon-Set ½" Iron Pipe		
WIT: 8" Poplar S84°E 39.63'		
12" Poplar N38°W 61.41'		
9" Birch S70°W 88.44'		

**B. Description of corner evidence found and/or method applied in restoring or reestablishing corner:**

Found ½" x 10" Iron Pipe laying on side 4" below surface 29'± South  
 Found nail on South side 12" W.Birch SW 88.44'  
 Found 11" Poplar stump S80°E 39.63'  
 Found fence wire on ground running East  
 Found rotten remains of Poplar stump N33°W 59'±  
 Measured S00°17'30"E 2624.94 to E-8  
 Measured N89°15'30"E 2624.47(recorded as 2625.56) to F-7  
 Accepted as the best available evidence of the position of the original corner.

**C. Description of monument for corner and accessories established to perpetuate locating the position of the corner:**

Mon-Set Std. Roscommon County Mon. stamped "T23N R4W E-7 31600"  
 WIT: Centerline road 3'± East  
 Std. nail & tag N. side 12" Maple S38½°E 58.11'  
 Std. nail & tag N. side 5" Maple S78°E 41.24'  
 Std. nail & tag SE side 7" Poplar S70°W 47.15'  
 Std. nail & tag SW side 5" Elm N33°W 61.91'  
 Set carsonite post N83°W 25.64'

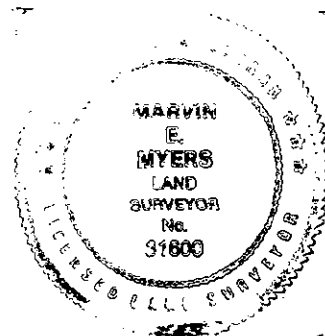

Signed by Marvin E. Myers

Date Dec 15, 1994

Surveyor's Michigan License No. 31600

LIBER 2 PAGE 101