

ROSCOMMON COUNTY SURVEY & PEER GROUP APPROVAL REMONUMENTATION

DATE _____ LAND CORNER RECORDATION CERTIFICATE Filing Requirement of Act 74, Mich. P.A. 1970

STATE OF MICHIGAN ROSCOMMON COUNTY RECORDED

COMMISSION

Located In: _____ Corner Code # _____

10 NOV 94 3:28 P.M.

ROBERT W. SMITH REGISTER OF DEEDS

ROSCOMMON COUNTY PEER GROUP APPROVAL

DATE 9-15-94

Register of Deeds Stamp & File Number

or corners in

Roscommon

(County)

Table with 3 columns: Survey Type, Survey Method (S/T), and Corner Code (R/W). Rows include Public Land Survey, Property Controlling in Section, and Miscellaneous Property in Sec.

1. Lot No. _____, Recorded Plat _____
2. Private Claims _____

Grid table with columns A-L and rows 2-13. A dot is marked at the intersection of column 10 and row 4.

Marvin E. Myers in a field survey on September 12, 1994

to hereby certify that under requirements of P.A. 74, Michigan P.A. of 1970, the corner points mentioned in lines 1 and 2 above were in conformance with regulations and rules therefore as required in the current manual of survey instructions of the United States Department of the Interior, Bureau of Land Management or by a decree of a Court of Law and/or that the corner points mentioned in lines 3, 4 and 5 above were in conformance with the rules of the Michigan Board of Land Surveyors or by a Decree of a Court of Law; established, re-established, monumented, re-monumented, recovered, found as expressed below:

NOTE: Not more than 4 corners, all in the same town and range, may be recorded on this certificate.

1. Description of original monument and accessories and/or subsequent restoration:

- Artemas Curtis 1852 Mon-Set Post WIT: 5" Tamarack N65°W 55 lks. 6" W.Pine S25°E 6 lks. George Henning Aug. 11, 1942 Mon-Fd. 1/2" Bar & 4"x4" Cedar Post WIT: 6" W.Birch N43°30'W 95.00' 6" Aspen S47°30'W 82.10' George Henning Dec. 1945 Mon. Fd. 1/2" Bar & Cedar Post WIT: None MSHD 8-5-60 Mon-4" Wood Stake & 1/2" Iron Rod on bank of ditch WIT: NE Cor. of Motel S50°E 126.55' NW Cor. of Motel S15°E 116.55' MSHD Norman Caldwell 1-5-61 Mon-Fd. 4" Wood Stake & 1/2" Iron Rod on bank of ditch WIT: NE Cor. Motel S50°E 126.55' NW Cor. Motel S15°E 116.55' Larry Cavanagh Aug. 8, 1975 L.326, pg.274 Mon-Not Given WIT: 2" Poplar N50°W 27.97' 4" Poplar S15°W 43.90'

- RCRC L.2, pg. 404 LCRC Mon-Cedar Post 282.05 West of C of Old 27 Larry Cavanagh 4-12-93 Mon-Fd. 1/2" Bar WIT: Spike 14" Willow S45°E 64.16' Spike 4" Poplar S20°W 21.42' Spike 4" Poplar N50°W 27.90' Spike F. Post side 29.70'

2. Description of corner evidence found and/or method applied in restoring or re-establishing corner. Found 1/2" x 3/4" Iron Bar; verified position by measurement to accessories of record and accepted as the best available evidence of the position of the original corner.

3. Description of monument for corner and accessories established to perpetuate locating the position of the corner:

- Mon-Set Std. Roscommon County Mon. stamped "C-4 T23N R4W 31600" WIT: Fd. Nail SW side 19" Willow S47°E 64.16' Fd. Nail E. side 6" Poplar S19°W 21.47' Fd. NE Cor. Motel S36°E 126.51' Fd. NW Cor. Motel S04°E 116.56' Set Carsonite Post East 4.00' Fd. Nail N. side 5" Poplar N55°W 27.95' G-3 N00°34'36"W 2581.22' G-5 S00°34'13"E 2581.76'

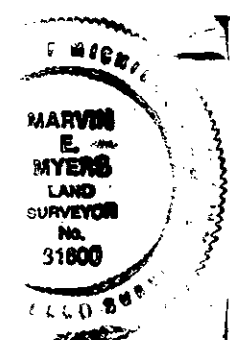

Signed by Marvin E. Myers

Date OCT 10, 1994

Surveyor's Michigan License No. 31600