

JAN 24 1996

ROSCOMMON COUNTY
PEER GROUP APPROVAL

DATE 12-28-94

ROSCOMMON COUNTY REMONUMENTATION
LAND CORNER RECORDATION CERTIFICATE
Filing Requirement of Act 74, Mich. P.A. 1970

COMMISSION

STATE OF MICHIGAN
ROSCOMMON COUNTY
RECORDED

For corners in

ROSCOMMON
(County)

Located In:

Corner Code ##

28 DEC 94 1:06 P.M.

- 1. Public Land Survey T 23N R 4W K-7
- 2. Property Controlling in Section S T R
- 3. Miscellaneous Property in Sec. S T R

SURVEY &
REMONUMENTATION

TO BE FILED IN LIBER 3 OF LAND CORNER

Register of Deeds Stamp & File Number

ROBERT W. SMITH
REGISTER OF DEEDS

COMMISSION

- 4. Lot No. _____, Recorded Plat _____
- 5. Private Claims _____

	A	B	C	D	E	F	G	H	I	J	K	L	M
2	6	5	4	3	2	1							
3													
4	7	8	9	10	11	12							
5													
6	18	17	16	15	14	13							
7													
8	19	20	21	22	23	24							
9													
10	30	29	28	27	26	25							
11													
12	31	32	33	34	35	36							
13													

Timothy L. Lapham, in a field survey on December, 19 94, do hereby certify that under requirements of P.A. 74, Michigan P.A. of 1970, the corner points mentioned in lines 1 and 2 above were in conformance with regulations and rules therefore as required in the current manual of survey instructions of the United States Department of the Interior, Bureau of Land Management or by a decree of a Court of Law and/or that the corner points mentioned in lines 3, 4 and 5 above were in conformance with the rules of the Michigan Board of Land Surveyors or by a Decree of a Court of Law; established, re-established, monumented, re-monumented, recovered, found as expressed below:

NOTE: Not more than 4 corners, all in the same town and range, may be recorded on this certificate.

- A. Description of original monument and accessories and/or subsequent restoration:
K-7: 1852 CURTIS, SET POST, ELM 18" N50W 40LK., CEDAR 10" S40E 10 LK., DATE/SURVEYOR UNKNOWN LCRC LIBER 2, CONCRETE MON, 4 WITNESSES
1943 UNRECORDED HENNING SURVEY, 1/2"x36" IRON BAR, NO WITNESSES
1943 UNRECORDED HENNING SURVEY, NO CORNER MATERIAL, NO WITNESSES
2/1945 HENNING PLAT OF NORTH BAY SHORES 2-62, 1/2"x36" IRON BAR, 2 WITS
1/1980 CAVANAGH LCRC 1-201, CONCRETE MONUMENT, 4 WITNESSES(1 SAME AS ABOVE)
10/12/1983 CAVANAGH SURVEY 449-513, NO CORNER MATERIAL, 3 WITNESSES SAME
5/28/1986 CAVANAGH SURVEY NOT RECORDED, NO CORNER MATERIAL 2 WITNESSES SAME
6/1992 MYERS SURVEY 615-337, NO CORNER MATERIAL OR WITNESSES
12/1992 CAVANAGH SRVEY NOT RECORDED, CONCRETE MONUMENT, 3 WITNESSES SAME
- B. Description of corner evidence found and/or method applied in restoring or reestablishing corner:
K-7: FOUND CONCRETE MONUMENT AND 2 WITNESSES, DISTANCES MATCH HENNING SURVEY TO EAST, ACCEPTED FOUND IRON AS BEST EVIDENCE OF ORIGINAL CORNER POSITION.
CORNER APPROVED AT PEER REVIEW MEETING 12-28, 1994. SEE DOSSIER FOR ADDITIONAL INFORMATION.

- C. Description of monument for corner and accessories established to perpetuate locating the position of the corner:
K-7: FOUND 4" DIAMETER CONCRETE MONUMENT WITH 1/2" REBAR
WEST 62.55 1/2" BAR
S66E 9.70 SET NAIL AND TAG IN 10' ASH
N47W 11.78 SET NAIL AND TAG IN 8" ASH
N50E 25.65 SET NAIL AND TAG IN 8" BIRCH
SOUTH 6.60 TO FACE OF FOUND OLD BLAZE IN 18" BIRCH
S34W 23.02 SET NAIL AND TAG IN 12" ASH

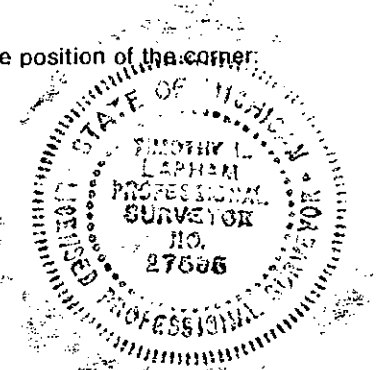

Signed by [Signature]

Date 12/27/94

Surveyor's Michigan License No. 27595