

JAN 24 1996

ROSCOMMON COUNTY
PEER GROUP APPROVAL
DATE 12-28-94
MEM

ROSCOMMON COUNTY REMONUMENTATION
LAND CORNER RECORDATION CERTIFICATE
Filing Requirement of Act 74, Mich. P.A. 1970

COMMISSION
STATE OF MICHIGAN
ROSCOMMON COUNTY
RECORDED

For corners in
ROSCOMMON
(County)

Located In:

Corner Code #

28 DEC 94 1:06 P.M.

- 1. Public Land Survey T 23N R 4W L-5
T ___ R ___
T ___ R ___
T ___ R ___
T ___ R ___
- 2. Property Controlling S ___ T ___ R ___
in Section S ___ T ___ R ___
- 3. Miscellaneous S ___ T ___ R ___
Property in Sec. S ___ T ___ R ___

SURVEY &
REMONUMENTATION

APR 05 1996

ROBERT W. SMITH
REGISTER OF DEEDS

TO BE FILED IN LIBER 3 OF LAND CORNERS
Register of Deeds Stamp & File Number

- 4. Lot No. _____, Recorded Plat COMMISSION
- 5. Private Claims _____

	A	B	C	D	E	F	G	H	I	J	K	L	M
2	6	5	4	3	2	1							
3													
4	7	8	9	10	11	12							
5													
6	18	17	16	15	14	13							
7													
8	19	20	21	22	23	24							
9													
10	30	29	28	27	26	25							
11													
12	31	32	33	34	35	36							
13													

I, Timothy L. Lapham, in a field survey on December, 19 94, do hereby certify that under requirements of P.A. 74, Michigan P.A. of 1970, the corner points mentioned in lines 1 and 2 above were in conformance with regulations and rules therefore as required in the current manual of survey instructions of the United States Department of the Interior, Bureau of Land Management or by a decree of a Court of Law and/or that the corner points mentioned in lines 3, 4 and 5 above were in conformance with the rules of the Michigan Board of Land Surveyors or by a Decree of a Court of Law; established, re-established, monumented, re-monumented, recovered, found as expressed below:

NOTE: Not more than 4 corners, all in the same town and range, may be recorded on this certificate.

A. Description of original monument and accessories and/or subsequent restoration:

- L-5: 1852 CURTIS, SET POST, HEMLOCK 8" N35E 23LK., CEDAR 7" S5W 5 LK.,
9/1943 HENNING SURVEY NO WITNESSES
9/1953 HENNING PLAT NORTH BAY VIEW 3-60, REFERENCED TO GOVERNMENT LOT 4 ONLY
8/1971 CAVANAGH SURVEY 253-620, REFERENCED TO GOVERNMENT LOT 4
5/1974 CAVANAGH SURVEY 290-140, REFERENCED TO GOVERNMENT LOT 4

B. Description of corner evidence found and/or method applied in restoring or reestablishing corner:

L-5: FOUND 4"x4"x4.7' SQUARE CEDAR STAKE SCRIBED 1/4, NO FURTHER EVIDENCE FOUND, THIS CORNER IS SIMILAR TO OTHER POSTS AS DESCRIBED BY HENNING IN 1943 SURVEY AND ACCEPTED BY HIM AT THAT TIME, ACCEPTED FOUND WOOD STAKE AS BEST EVIDENCE OF ORIGINAL CORNER POSITION. CORNER APPROVED AT PEER REVIEW MEETING 12-28, 1994. SEE DOSSIER FOR ADDITIONAL INFORMATION.

C. Description of monument for corner and accessories established to perpetuate locating the position of the corner:

- L-5: SET 3/4"x60" BLACK PIPE 50" INTO GROUND WITH PLASTIC PS CAP #27595
N25E 14.64 SET NAIL AND TAG IN SE FACE OF 8" ASH
S42E 26.21 SET NAIL AND TAG IN NE FACE OF 14" ASH
S50W 30.46 SET NAIL AND TAG IN NW FACE OF 12" ASH
EAST 2.91 FACE OF CARSONITE POST

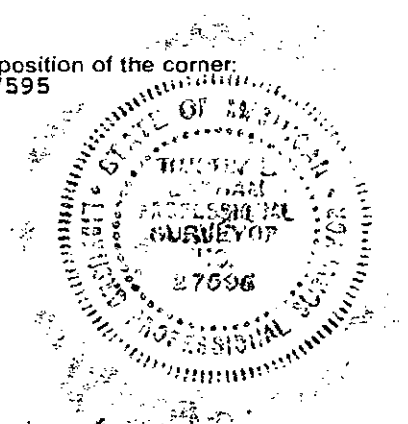

Signed by [Signature] Date 12/27/94
Surveyor's Michigan License No. 27595