

**SURVEY &
REMONUMENTATION**

4020

MAY 28 1997

LAND CORNER RECORDATION CERTIFICATE
COMMISSION

Filing Requirement of Act 74, Mich. P.A. 1970

For corners in

Roscommon <small>(County)</small>	Located In:	Corner Code #
1. Public Land Survey	T <u>23N</u> R <u>1W</u>	<u>A - 5</u>
	T _____ R _____	_____
	T _____ R _____	_____
	T _____ R _____	_____
2. Property Controlling in Section	S _____ T _____ R _____	_____
	S _____ T _____ R _____	_____
3. Miscellaneous Property in Sec.	S _____ T _____ R _____	_____
	S _____ T _____ R _____	_____
4. Lot No. _____	Recorded Plat _____	
5. Private Claims _____		

TO BE FILED IN LIBER 3 OF LAND CORNERS

STATE OF MICHIGAN
ROSCOMMON COUNTY
RECORDED

17 JUN 96 3:38 P.M.

ROBERT W. SMITH
Register of Deeds Stamp & File Number

Marvin E. Myers, in a field survey on March 27, 19 96,
do hereby certify that under requirements of P.A. 74, Michigan P.A. of 1970, the corner points mentioned
in lines 1 and 2 above were in conformance with regulations and rules therefore as required in the
current manual of survey instructions of the United States Department of the Interior, Bureau of Land
Management or by a decree of a Court of Law and/or that the corner points mentioned in lines 3, 4 and 5
above were in conformance with the rules of the Michigan Board of Land Surveyors or by a Decree of a
Court of Law; established, re-established, monumented, re-monumented, recovered, found as
expressed below:

**NOTE: Not more than 4 corners, all in the same town and range, may be recorded
on this certificate.**

A. Description of original monument and accessories and/or subsequent restoration:

GLO-William Burt 1852
Mon-Set Post
WIT: 8" W.Pine S23°W 6 lks.
10" W.Birch N23½°W 30 lks.

B. Description of corner evidence found and/or method applied in restoring or reestablishing corner:

No evidence of the original monument or accessories were found. Accepted intersection of old barb wire fence as
the best available evidence. Intersection of old barbed wire fences extending West and South. This position
is harmoniously related with identified existing corners in the area; has long been recognized by owners of the
adjacent lands as the corner and is accepted as the best available evidence of original corner position.
A-5 to A-6 AZ 180°44'31" 2614.87'

ROSCOMMON COUNTY
PEER GROUP APPROVAL
DATE April 5, 1996

Marvin E. Myers
Marvin E. Myers, P.S.
County Surveyor

C. Description of monument for corner and accessories established to perpetuate locating the position of the corner:

Monument - Set standard Roscommon County Monument
WIT: Set nail & tag W. side 3" Balsam N18°E 9.30'
Set nail & tag E. side 3" W.Pine South 4.69'
Set nail & tag S. side 5" Balsam N55°W 17.81'
Set nail & tag SW side 12" Maple S60°W 32.33'

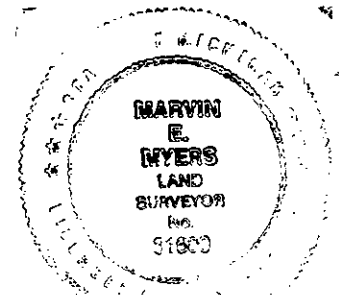

Signed by *Marvin E. Myers* Date May 17, 1996
Surveyor's Michigan License No. 31600

LIBER 3 PAGE 292