

**SURVEY &  
REMONUMENTATION**

4021

MAY 28 1997

**LAND CORNER RECORDATION CERTIFICATE  
Filing Requirement of Act 74, Mich. P.A. 1970**

For corners in Roscommon _____ (County)	Located In:	Corner Code #
1. Public Land Survey	T 23N R 1W	A - 6
	T _____ R _____	_____
	T _____ R _____	_____
	T _____ R _____	_____
2. Property Controlling in Section	S _____ T _____ R _____	_____
	S _____ T _____ R _____	_____
3. Miscellaneous Property in Section	S _____ T _____ R _____	_____
	S _____ T _____ R _____	_____
4. Lot No. _____, Recorded Plat _____		
5. Private Claims _____		

TO BE FILED IN LIBER 3 OF LAND CORNER  
STATE OF MICHIGAN  
ROSCOMMON COUNTY  
RECORDED  
17 JUN 96 3:38 P.M.  
ROBERT W. SMITH  
REGISTER OF DEEDS  
Register of Deeds Stamp & File Number

	A	B	C	D	E	F	G	H	I	J	K	L	M
2	6		5		4		3		2		1		
3													
4	7		8		9		10		11		12		
5													
6	18		17		16		15		14		13		
7													
8	19		20		21		22		23		24		
9													
10	30		29		28		27		26		25		
11													
12	31		32		33		34		35		36		
13													

I, Marvin E. Myers, in a field survey on March 27, 19 96, do hereby certify that under requirements of P.A. 74, Michigan P.A. of 1970, the corner points mentioned in lines 1 and 2 above were in conformance with regulations and rules therefore as required in the current manual of survey instructions of the United States Department of the Interior, Bureau of Land Management or by a decree of a Court of Law and/or that the corner points mentioned in lines 3, 4 and 5 above were in conformance with the rules of the Michigan Board of Professional Surveyors or by a Decree of a Court of Law; established, re-established, monumented, re-monumented, recovered, found as expressed below:

**NOTE: Not more than 4 corners, all in the same town and range, may be recorded on this certificate.**

**A. Description of original monument and accessories and/or subsequent restoration:**

GLO-William Burt 1852  
Mon-Set Post  
WIT: 12" Hemlock S57°W 40 lks.  
13" Hemlock N64°W 17 lks.

**B. Description of corner evidence found and/or method applied in restoring or reestablishing corner:**

No evidence of the original monument or accessories were found. Old barb wire fence North and South. Set midway on old North - South fence line. This position is harmoniously related with identified existing corners in the area. Has long been recognized by owners of the adjacent lands as the corner and is accepted as the best available evidence of the position of the original corner position.

**ROSCOMMON COUNTY  
PEER GROUP APPROVAL  
DATE April 5, 1996**

*Marvin E. Myers*  
**Marvin E. Myers, P.S.  
County Surveyor**

**C. Description of monument for corner and accessories established to perpetuate locating the position of the corner:**

Monument - Set Standard Roscommon County Monument  
WIT: Carsonite Post West 0.60'  
Set nail & tag SW side 5" W.Pine S52°E 42.91'  
Set nail & tag E. side 20" W.Pine South 33.02'  
Set nail & tag SE side 7" Poplar S73°W 31.11'  
Set nail & tag W. side 4" X 5" wood fence post North 20.00'  
NE corner 4" X 5" bird house post N26°W 60.44'

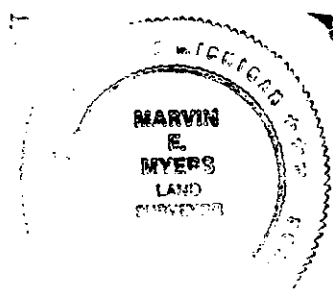

Signed by *Marvin E. Myers*  
Surveyor's Michigan License No. 31600

Date May 17, 1996

LIBER 3 PAGE 293