

**SURVEY & REMONUMENTATION**

4022

MAY 28 1997

**LAND CORNER RECORDATION CERTIFICATE**  
**COMMISSION**  
 Filing Requirement of Act 74, Mich. P.A. 1970

For corners in  
 Roscommon  
 (County)

Located In: Corner Code #

- |                                       |            |       |
|---------------------------------------|------------|-------|
| 1. Public Land Survey                 | T 23N R 1W | A - 7 |
|                                       | T R        |       |
|                                       | T R        |       |
|                                       | T R        |       |
| 2. Property Controlling in Section    | S T R      | "     |
|                                       | S T R      |       |
| 3. Miscellaneous Property in Sec.     | S T R      |       |
|                                       | S T R      |       |
| 4. Lot No. _____, Recorded Plat _____ |            |       |
| 5. Private Claims _____               |            |       |

TO BE FILED IN LIBER 3 OF LAND CORNER

STATE OF MICHIGAN  
 ROSCOMMON COUNTY  
 RECORDED

17 JUN 96 3:38 P.M.

ROBERT W. SMITH  
 REGISTER OF DEEDS  
 Register of Deeds Stamp & File Number

I, Marvin E. Myers, in a field survey on February 13, 1996, do hereby certify that under requirements of P.A. 74, Michigan P.A. of 1970, the corner points mentioned in lines 1 and 2 above were in conformance with regulations and rules therefore as required in the current manual of survey instructions of the United States Department of the Interior, Bureau of Land Management or by a decree of a Court of Law and/or that the corner points mentioned in lines 3, 4 and 5 above were in conformance with the rules of the Michigan Board of Land Surveyors or by a Decree of a Court of Law, established, re-established, monumented, re-monumented, recovered, found as expressed below:

	A	B	C	D	E	F	G	H	I	J	K	L	M
2	6		5		4		3		2		1		
3													
4	7		8		9		10		11		12		
5													
6	18		17		16		15		14		13		
7													
8	19		20		21		22		23		24		
9													
10	30		29		28		27		26		25		
11													
12	31		32		33		34		35		36		
13													

**NOTE: Not more than 4 corners, all in the same town and range, may be recorded on this certificate.**

**A. Description of original monument and accessories and/or subsequent restoration:**

GLO-William Burt 1852	G.D. Henning Feb. 9, 1946	M. Schaaf
Mon-Set Post	Mon-1 1/2" Pipe & Post	Mon-Fd. or established and replaced
WIT: 12" Cedar S42°W 21 lks.	Chaining from East & West	
12" Cedar N45°W 13 lks.	Confirm position	
	No witnesses near	

**B. Description of corner evidence found and/or method applied in restoring or reestablishing corner:**

Monument - found 1 1/2" pipe in concrete leaning Northwesterly (left in place) Set 3/4" x 54" pipe & cap at base  
 WIT: Iron fence posts East, South & West  
 Accepted as best available evidence of the position of the original corner.

**ROSCOMMON COUNTY**  
**PEER GROUP APPROVAL**  
 DATE April 5, 1996

*Marvin E. Myers*  
**Marvin E. Myers, P.S.**  
 County Surveyor

**C. Description of monument for corner and accessories established to perpetuate locating the position of the corner:**

Monument - Set 3/4" ID X 54" pipe & cap "MEM 31600" at base of found pipe  
 WIT: Iron fence post S80°E 1.00'±  
 Set carsonite post South 2.60'  
 Set nail & tag E. side 17" pine stump N32°E 39.88'  
 Set 4' wood stake 3' into ground S40°E 7.75'  
 Set 4' wood stake 3' into ground N80°W 7.50'  
 Iron fence posts East, West & South

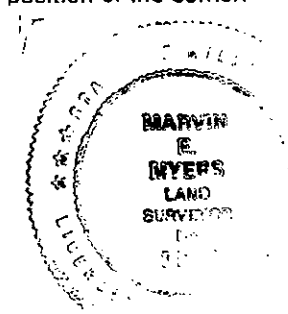

Signed by Marvin E. Myers

Date May 17, 1996

Surveyor's Michigan License No. 31600