

5487

JAN 24 1996

LAND CORNER RECORDATION CERTIFICATE
Filing Requirement of Act 74, Mich. P.A. 1970

For corners in

<u>Roscommon</u> (County)	Located In:	Corner Code #
1. Public Land Survey	T <u>23N</u> R <u>1W</u>	<u>E-7</u>
	T _____ R _____	_____
	T _____ R _____	_____
	T _____ R _____	_____
2. Property Controlling in Section	S _____ T _____ R _____	<u>SURVEY & REMONUMENTATION</u>
3. Miscellaneous Property in Sec.	S _____ T _____ R _____	<u>APR 05 1996</u>
4. Lot No. _____, Recorded Plat _____	<u>COMMISSION</u>	
5. Private Claims _____	_____	

STATE OF MICHIGAN
ROSCOMMON COUNTY
RECORDED

28 AUG 95 1:08 P.M.

ROBERT W. SMITH
REGISTER OF DEEDS

to be filed in Liber 3 of Land Corners
Register of Deeds Stamp & File Number

I, Larry L. Cavanagh, in a field survey on August, 1995, do hereby certify that under requirements of P.A. 74, Michigan P.A. of 1970, the corner points mentioned in lines 1 and 2 above were in conformance with regulations and rules therefore as required in the current manual of survey instructions of the United States Department of the Interior, Bureau of Land Management or by a decree of a Court of Law and/or that the corner points mentioned in lines 3, 4 and 5 above were in conformance with the rules of the Michigan Board of Land Surveyors or by a Decree of a Court of Law; established, re-established, monumented, re-monumented, recovered, found as expressed below:

NOTE: Not more than 4 corners, all in the same town and range, may be recorded on this certificate.

A. Description of original monument and accessories and/or subsequent restoration:

William A. Burt 1852
Set post and re-established old corner of sections
W. Oak 10" N10°W 10 links
W. Pine 10" S46°W 40 links

Ostling Survey 1964
1 1/4" pipe
BT 7" W. Oak S25°E 46.5'
BT 16" B. Oak S57°W 57.7'
NBT 10" Maple N28°E 52.7'

George D. Henning 1944
fd 1 1/4" pipe and post
marked BT W. Oak 7" S25 1/4°E 46.5'
marked BT B. Oak 12" S57°W 52.7'
US BT not identified

B. Description of corner evidence found and/or method applied in restoring or reestablishing corner:

No original evidence found
Found 1 1/4" pipe called out by Henning & Ostling surveys
No other evidence found

C. Description of monument for corner and accessories established to perpetuate locating the position of the corner:

Set Roscommon County Standard monument stamped 1995, 17614
S20°E Nail & tag in 6" W. Oak 45.69'
N45°E Nail & tag in 7" W. Oak 20.70'
N47°W Nail & tag in 10" W. Oak 4.60'
S50°W Nail & tag in 4" Maple 24.08'

Is accepted as the best available evidence of the position of the original corner.

ROSCOMMON COUNTY
PEER GROUP APPROVAL
DATE 8-22-1995

MRC

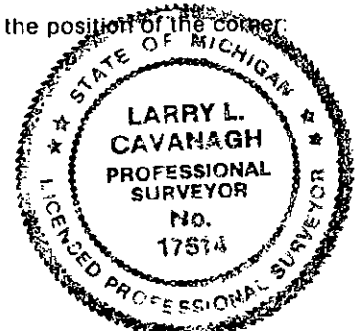

Signed by Larry L. Cavanagh
Surveyor's Michigan License No. 17614

Date Aug 25, 1995

Peer Group Approved 8/22/95

FORM APPROVED BY MICHIGAN STATE BOARD OF LAND SURVEYORS, JAN. 28, 1971
REVISED MAY 14, 1975
REVISED JAN., 1983

LIBER 3 PAGE 247