

**LAND CORNER RECORDATION CERTIFICATE**  
**Filing Requirement of Act 74, Mich. P.A. 1970**

For corners in

Roscommon  
 (County)

Located In:

Corner Code #

STATE OF MICHIGAN  
 ROSCOMMON COUNTY  
 RECORDED

6 MAY 99 2:09 P.M.

ROBERT W. SMITH  
 REGISTER OF DEEDS

1. Public Land Survey	T <u>24N</u> R <u>2W</u>	<u>A-7</u>
	T <u>24N</u> R <u>3W</u>	<u>M-7</u>
	T _____ R _____	_____
	T _____ R _____	_____
2. Property Controlling in Section	S _____ T _____ R _____	_____
	S _____ T _____ R _____	_____
3. Miscellaneous Property in Sec.	S _____ T _____ R _____	_____
	S _____ T _____ R _____	_____

To be filed in Liber 3 of Land Corners  
**Register of Deeds Stamp & File Number**

4. Lot No. \_\_\_\_\_, Recorded Plat \_\_\_\_\_  
 5. Private Claims \_\_\_\_\_

A	B	C	D	E	F	G	H	I	J	K	L	M
1												
2	6	5	4	3	2	1						
3												
4	7	8	9	10	11	12						
5												
6	18	17	16	15	14	13						
7												
8	19	20	21	22	23	24						
9												
10	30	29	28	27	26	25						
11												
12	31	32	33	34	35	36						
13												

I, Marvin E. Myers, in a field survey on March, 1999 do hereby state that under requirements of P.A. 74, Michigan P.A. of 1970, the corner points mentioned in lines 1 and 2 above were in conformance with regulations and rules therefore as required in the current manual of survey instructions of the United States Department of the Interior, Bureau of Land Management or by a decree of a Court of Law and /or that the corner points mentioned in lines 3, 4 and 5 above were in conformance with the rules of the Michigan Board of Land Surveyors or by a Decree of a Court of Law; established, re-established, monumented, recovered, found as expressed below:

**NOTE: Not more than 2 corners, all in the same town and range, may be recorded on this certificate.**

**A. Description of original monument and accessories and/or subsequent restoration:**

G.L.O - 1838  
 John Brink D.S.  
 Mon. - Post  
 Wit: 10" P. Pine 10 cor- old corner

Roscommon County Records (Liber 2, Page 516)  
 Mon: 1" iron pipe  
 Wit: 3" Jack Pine N24°E 65.12' 4" Jack Pine S23°E 28.23'  
 Twin 10" Jack Pine S64°W 46.46'

MDOT 1966  
 Mon - 1/2" Iron Pipe

Marvin E. Myers, P.S. #31600 March 1992  
 LCRC, Liber 3, Page 73  
 Mon: Found 1/2" Bar  
 Wit: PK in 5" Jack Pine S46°E 39.00' PK in 4" Jack Pine N26°E 65.12'  
 E. end culvert N30°W 102.95' W. to line of Marker Posts 49.00' (gas line)

DNR June 26, 1995  
 C. Roser, P.S.  
 Mon - 1/2" pin in 1 1/4" pipe  
 in mon box in East ditch line  
 of South bound I-75

DNR June 4, 1997  
 C. Kiskila, P.S.  
 Mon - 1/2" pin in 1 1/4" pipe in Mon box  
 in East ditch line of South bound I-75  
 (from previous survey)

**B. Description of corner evidence found and/or method applied in restoring or reestablishing corner:**

Found 1/2" bar inside a 1" iron pipe in pavement box in the median of I-75.  
 Wit: PK in 5" Jack Pine S46°E 39.00' PK in 4" Jack Pine N26°E 65.12'  
 E. end culvert N30°W 102.95' West to line of Marker Posts 49.00' (gas line)  
 Found DNR Location Marker Post West 1.28'

Accepted 1/2" pipe inside 1 1/4" pipe in pav't monument box as the best available evidence of the position of the Original Corner set Standard Roscommon County monument on top of 1/2" bar and pipe in monument box.

**C. Description of monument for corner and accessories established to perpetuate locating the position of the corner:**

Mon - Standard Roscommon County corner on top of 1/2" bar & 1" pipe inside pavement box  
 Wit: PK in 5" Jack Pine S46°E 39.00' PK in 4" Jack Pine N26°E 65.12'  
 E. end culvert N30°W 102.95' W. to line of Marker Posts 49.00' (gas line)  
 Found DNR Location Marker Post West 1.28' Set Carsonite Post South 2.0'

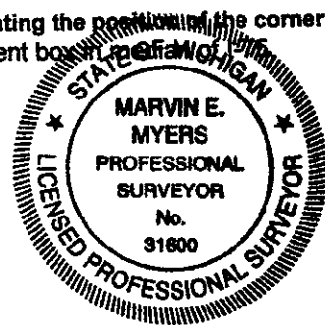

**ROSCOMMON COUNTY**  
**PEER GROUP APPROVAL**

DATE April 19, 1999

Signed by Marvin E. Myers, P.S.  
 County Surveyor  
 Surveyor's Michigan License No. 31600

Date May 4, 1999