

ROSCOMMON COUNTY
PEER GROUP APPROVAL
DATE Sept 15, 1994

9269

SURVEY & LAND CORNER RECORDATION CERTIFICATE
REMONUMENTATION
Filing Requirement of Act 74, Mich. P.A. 1970

STATE OF MICHIGAN
ROSCOMMON COUNTY
RECORDED

21 DEC 94 8:38 A.M.

ROBERT W. SMITH
REGISTER OF DEEDS

For corners in

Roscommon (County) APR 24 1995 Located In: Corner Code #

- 1. Public Land Survey COMMISSION 24N R 2W H - 2
 - T _____ R _____
 - T _____ R _____
 - T _____ R _____
- 2. Property Controlling in Section S _____ T _____ R _____
S _____ T _____ R _____
- 3. Miscellaneous Property in Sec. S _____ T _____ R _____
S _____ T _____ R _____

Register of Deeds Stamp & File Number

- 4. Lot No. _____, Recorded Plat _____
- 5. Private Claims _____

I, Marvin E. Myers, in a field survey on May 3, 19 94, do hereby certify that under requirements of P.A. 74, Michigan P.A. of 1970, the corner points mentioned in lines 1 and 2 above were in conformance with regulations and rules therefore as required in the current manual of survey instructions of the United States Department of the Interior, Bureau of Land Management or by a decree of a Court of Law and/or that the corner points mentioned in lines 3, 4 and 5 above were in conformance with the rules of the Michigan Board of Land Surveyors or by a Decree of a Court of Law; established, re-established, monumented, re-monumented, recovered, found as expressed below:

NOTE: Not more than 4 corners, all in the same town and range, may be recorded on this certificate.

	A	B	C	D	E	F	G	H	I	J	K	L	M
2	6		5		4			●		2			1
3													
4	7		8		9		10		11		12		
5													
6	18		17		16		15		14		13		
7													
8	19		20		21		22		23		24		
9													
10	30		29		28		27		26		25		
11													
12	31		32		33		34		35		36		
13													

A. Description of original monument and accessories and/or subsequent restoration:
None

B. Description of corner evidence found and/or method applied in restoring or reestablishing corner:
Established position at intersection of N-S and E-W $\frac{1}{2}$ lines.
Accepted as a careful and faithful establishment of the position of the corner.

C. Description of monument for corner and accessories established to perpetuate locating the position of the corner:
Mon-Set Standard Roscommon County monument mark cap " 31600".
Wit-Set nail & tag SE side 8" J. Pine N35°E 5.04
Set nail & tag NE side 6" J. Pine S57°E 23.22
Set nail & tag SW side 8" J. Pine N59°W 34.60
Set nail & tag W. side 6" J. Pine S08°W 39.53

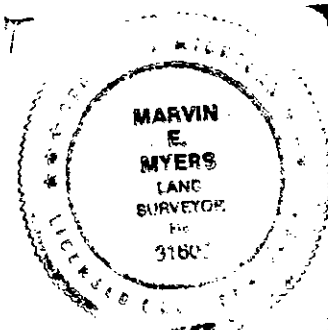

Signed by Marvin E. Myers Date Dec 15, 1994
Surveyor's Michigan License No. 31600

LIBER 3 PAGE 206