

7870

SURVEY & REMONUMENTATION

LAND CORNER RECORDATION CERTIFICATE
Filing Requirement of Act 74, Mich. P.A. 1970

APR 07 1998

For corners in Roscommon (County)

Located In:

Corner Code #

SECTION

STATE OF MICHIGAN
ROSCOMMON COUNTY
RECORDED

30 OCT 97 12:29 P.M.

ROBERT W. SMITH
REGISTER OF DEEDS
FILE IN LIBER REGISTER OF DEEDS CORNERS
Register of Deeds Stamp & File Number

- 1. Public Land Survey T 24N R 2W E - 7
2. Property Controlling in Section S T R
3. Miscellaneous Property in Section S T R

- 4. Lot No. , Recorded Plat
5. Private Claims

I, Marvin E. Myers, in a field survey on August, 19 97 do hereby certify that under requirements of P.A. 74, Michigan P.A. of 1970, the corner points mentioned in lines 1 and 2 above were in conformance with regulations and rules therefore as required in the current manual of survey instructions of the United States Department of the Interior, Bureau of Land Management or by a decree of a Court of Law and/or that the corner points mentioned in lines 3, 4 and 5 above were in conformance with the rules of the Michigan Board of Professional Surveyors or by a Decree of a Court of Law; established, re-established, monumented, re-monumented, recovered, found as expressed below:

NOTE: Not more than 4 corners, all in the same town and range, may be recorded on this certificate.

Grid table with columns A-L and rows 2-13. A dot is marked at the intersection of column D and row 7.

A. Description of original monument and accessories and/or subsequent restoration:

GLO - 1852 Wm. Burt, D.S. LCRC Liber 1, pg. 177 J. Wilcox, P.S. #14102
Mon. - Post June 1980
WIT: 12" Hemlock S87°46'E 247 lks. Mon. - Fd. boat spike in mon. box
12" Hemlock N67°E 24 lks. WIT: 10" Apple N18°W 152.53'
12" Beech S34°W 34 lks. 10" Tw. Maple S85°E 82.10'
Telephone riser N70°E 35.39'
Stop sign post S85°W 28.2'
On old fenceline East

B. Description of corner evidence found and/or method applied in restoring or reestablishing corner:

Found 7" boat spike in watervalue box (no cover on box) over 12" lag bolt anchor, over 1 1/2" x 24" pipe replaced with standard Roscommon County monument
Found nail in 10" Tw. Maple S75°E 82.16'
10" Apple blaze N15°W 152.69'
Stop sign post S84°W 30.53'
Telephone riser N79°E 35.34'
Accepted as the best available evidence of the position of the original corner

ROSCOMMON COUNTY
PEER GROUP APPROVAL
DATE OCT 21 1997

C. Description of monument for corner and accessories established to perpetuate locating the position of the corner:

Set standard Roscommon County monument in pavement monument box
WIT: Nail & tag in N. side 5" Norway S84°W 139.10'
Nail & tag in W. side 5" Juneberry N27°W 139.94'
Carsonite post S86°E 37.95'
Nail & tag in 7" Poplar S34°E 63.04'

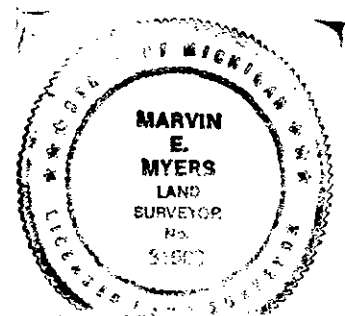

Signed by [Signature]
Surveyor's Michigan License No. 31600

Date October 25, 1997