

5081

JAN 24 1996

LAND CORNER RECORDATION CERTIFICATE  
Filing Requirement of Act 74, Mich. P.A. 1970

For corners in  
Roscommon  
(County)

Located In: \_\_\_\_\_ Corner Code # \_\_\_\_\_

1. Public Land Survey T 24N R 4W G - 9  
T \_\_\_\_\_ R \_\_\_\_\_  
T \_\_\_\_\_ R \_\_\_\_\_  
T \_\_\_\_\_ R \_\_\_\_\_

2. Property Controlling S \_\_\_\_\_ T \_\_\_\_\_ R \_\_\_\_\_  
in Section S \_\_\_\_\_ T \_\_\_\_\_ R \_\_\_\_\_

3. Miscellaneous S \_\_\_\_\_ T \_\_\_\_\_ R \_\_\_\_\_  
Property in Section S \_\_\_\_\_ T \_\_\_\_\_ R \_\_\_\_\_

4. Lot No. \_\_\_\_\_, Recorded Plat \_\_\_\_\_

5. Private Claims \_\_\_\_\_

STATE OF MICHIGAN  
ROSCOMMON COUNTY  
RECORDED

14 AUG 95 3:46 P.M.

ROBERT W. SMITH  
REGISTER OF DEEDS

To be filed in Liber 3 of Land Corner  
Register of Deeds Stamp & File Number

COMMISSION

A	B	C	D	E	F	G	H	I	J	K	L	M
2	6	5	4	3	2	1						
3												
4	7	8	9	10	11	12						
5												
6	18	17	16	15	14	13						
7												
8	19	20	21	22	23	24						
9												
10	30	29	28	27	26	25						
11												
12	31	32	33	34	35	36						
13												

I, Marvin E. Myers, in a field survey on July 10, 19 95, do hereby certify that under requirements of P.A. 74, Michigan P.A. of 1970, the corner points mentioned in lines 1 and 2 above were in conformance with regulations and rules therefore as required in the current manual of survey instructions of the United States Department of the Interior, Bureau of Land Management or by a decree of a Court of Law and/or that the corner points mentioned in lines 3, 4 and 5 above were in conformance with the rules of the Michigan Board of Professional Surveyors or by a Decree of a Court of Law; established, re-established, monumented, re-monumented, recovered, found as expressed below:

NOTE: Not more than 4 corners, all in the same town and range, may be recorded on this certificate.

A. Description of original monument and accessories and/or subsequent restoration:

GLO-A.P. Brewer Oct. 1852 L.2, pg.566 LCRC  
Mon-Post Mon- $\frac{1}{2}$ " rod in intersection  
WIT: 16" Y.Pine N25°E 82 lks. WIT: 12" Poplar N60°E 57.47'  
30" Y.Pine S11°W 80 lks. P.P. S40°E 51.38'  
24" B.Oak S40°W 47.42'

G.D. Henning Oct. 1948 L.L. Cavanagh Nov. 1973 L.1, pg.95  
Mon- $\frac{1}{2}$ "x48" Iron Bar Mon-Fd. 3/4" Iron rod  
in center of roads placed  $\frac{1}{2}$ "x24" steel bar to surface  
WIT: 16" B.Oak N65 $\frac{1}{2}$ °W 83.80' WIT: 16" B.Oak N65°W 83.40'  
10" B.Oak S34°E 93.00' 10" B.Oak S34°E 94.30'

B. Description of corner evidence found and/or method applied in restoring or reestablishing corner:

Found  $\frac{1}{2}$ " x 30" bar over top of  $1\frac{1}{2}$ " x 30" pipe. Replaced with standard Roscommon County Monument.

ROSCOMMON COUNTY  
PEER GROUP APPROVAL  
DATE Aug 8<sup>th</sup> 1995

Marvin E. Myers  
Marvin E. Myers, P.S.  
County Surveyor

C. Description of monument for corner and accessories established to perpetuate locating the position of the corner:

Mon-Std. Roscommon County Monument  
WIT: Fd. spike NW side P.P. N55°E 40.81'  
Fd. spike NE side guy pole N41°W 41.48'  
Nail & tag SW side P.P. S32°E 43.94'  
Nail & tag N. side Oak N86°W 77.86'

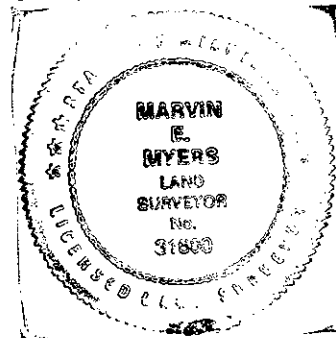

Signed by Marvin E. Myers  
Surveyor's Michigan License No. 31600

Date Aug 9<sup>th</sup> 1995

LIBER 3 PAGE 232