

APPROVED BY PEER GROUP
P.A. 345 OF 1990
SAGINAW COUNTY

B. 28-96

SAGINAW COUNTY REMONUMENTATION

LAND CORNER RECORDATION CERTIFICATE
Filing Requirement of Act 74, Mich. P.A. 1970

For corners in

Saginaw Located in: City of Saginaw Corner Code #
(County)

- 1. Public Land Survey T 12N R 5E A-6
T R
- 2. Property Controlling S T R
in Section S T R
- 3. Miscellaneous S T R
Property in Sec. S T R

- 4. Lot No. _____, Recorded Plat _____
- 5. Private Claims _____

I, Brian D Ferguson, in a field survey on August 23, 19 96 do hereby state that under requirements of P.A. 74, Michigan P.A. of 1970, the corner points mentioned in lines 1 and 2 above were in conformance with regulations and rules therefore as required in the current manual of survey instructions of the United States Department of the Interior, Bureau of Land Management or by a decree of a Court of Law and/or that the corner points mentioned in lines 3, 4 and 5 above were in conformance with the rules of the Michigan Board of Land Surveyors or by a Decree of a Court of Law; established, re-established, monumented, recovered, found as expressed below:

NOTE: Not more than 2 corners, all in the same town and range, may be recorded on this certificate.

A. Description of original monument and accessories and/or subsequent restoration:

A-6 Corner not set in original government survey.
No LCRC.
No plat.
No surveys.

B. Description of corner evidence found and/or method applied in restoring or reestablishing corner:

A-6 Re-set corner from city re-survey maps after re-setting M-6 in T12N - R4E.
Position agrees with City of Saginaw re-survey map.
Accepted by peer group as best available evidence of original corner.

C. Description of monument for corner and accessories established to perpetuate locating the position of the corner:

A-6 Set 5/8" steel bar with Saginaw County Remon. cap.
S0°W 17.16 Saginaw County Remon. cap M-6, T12N - R4E.
N2°W 12.28 Spike E face 12" poplar.
S10°W 68.40 Spike NW face 10" elm.
S30°E 40.65 Spike W face 10" tree.

Signed by Brian D Ferguson
Surveyor's Michigan License No. 26454

Date 9-27-96

RECORDED & FILED
SEP 27 11 42 AM 1996
MILDRED H. JODAK
REGISTER OF DEEDS
SAGINAW COUNTY MICH.

Liber 7 Page 72
Register of Deeds Stamp & File Number

1	A	B	C	D	E	F	G	H	I	J	K	L	M
2	6		5		4		3		2		1		
3													
4	7		8		9		10		11		12		
5													
6	18		17		16		15		14		13		
7													
8	19		20		21		22		23		24		
9													
10	30		29		28		27		26		25		
11													
12	31		32		33		34		35		36		
13													

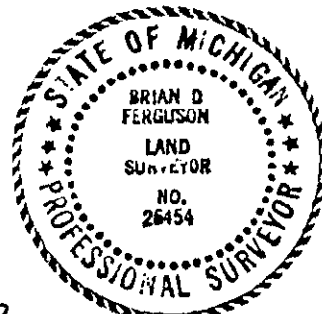

REMONUMENTATION

MAY 16 1997

COMMISSIONER