

7-21/BDP

SAGINAW COUNTY REMONUMENTATION

RECORDED/FILED

LAND CORNER RECORDATION CERTIFICATE
Filing Requirement of Act 74, Mich. P.A. 1970

1999 SEP 29 A 8:08

MILDRED M. DODAK
REGISTER OF DEEDS
SAGINAW COUNTY, MI.
LIBER 2144 PAGE 787

For corners in

KOCHVILLE TOWNSHIP

	Located in:	Corner Code #
<u>SAGINAW</u> (County)		
1. Public Land Survey	T <u>13</u> N R <u>4</u> E	<u>E-11</u>
	T _____ R _____	_____
2. Property Controlling in Section	S _____ T _____ R _____	_____
	S _____ T _____ R _____	_____
3. Miscellaneous Property in Sec.	S _____ T _____ R _____	_____
	S _____ T _____ R _____	_____

Lib 8 Page 52

Register of Deeds Stamp & File Number

4. Lot No. _____, Recorded Plat _____
5. Private Claims _____

I, Brian D Ferguson, in a field survey on JUNE 28, 19 99 do hereby state that under requirements of P.A. 74, Michigan P.A. of 1970, the corner points mentioned in lines 1 and 2 above were in conformance with regulations and rules therefore as required in the current manual of survey instructions of the United States Department of the Interior, Bureau of Land Management or by a decree of a Court of Law and/or that the corner points mentioned in lines 3, 4 and 5 above were in conformance with the rules of the Michigan Board of Land Surveyors or by a Decree of a Court of Law; established, re-established, monumented, recovered, found as expressed below:

NOTE: Not more than 2 corners, all in the same town and range, may be recorded on this certificate.

	A	B	C	D	E	F	G	H	I	J	K	L	M
1													
2	6			5		4		3		2		1	
3													
4	7			8		9		10		11		12	
5													
6	18			17		16		15		14		13	
7													
8	19			20		21		22		23		24	
9													
10	30			29		28		27		26		25	
11													
12	31			32		33		34		35		36	
13													

A. Description of original monument and accessories and/or subsequent restoration:

WOOD POST SET BY J. WAMPLER IN 1822, NO EVIDENCE OF ORIGINAL CORNER REMAINS
LCRC BY GERALD MCKELVEY IN 1972, L 1, PG 210
LCRC BY JOHN MARTIN IN 1977, L 7, PG 75
SURVEYS IN L 1563, PG 1458 & L 1737, PG 1683

SURVEY &
RE...

MAR 09 2000

SECTION

B. Description of corner evidence found and/or method applied in restoring or reestablishing corner:

FOUND 3/4" PIPE IN MONUMENT BOX PER WITNESSES ON LCRC'S AND SURVEYS
VERIFIED LOCATION BY DISTANCES TO ADJOINING CORNERS FROM RECORDED SURVEYS

C. Description of monument for corner and accessories established to perpetuate locating the position of the corner:

SET 5/8" REBAR W/ 3" BRASS CAP IN MONUMENT BOX
N50W 44.70' NAIL & SHINNER NE FCE PWR POLE
S35E 80.20' TOP CTR BOLT ON HYDRANT
S50E 70.24' NAIL IN W FCE PWR POLE
N45E 54.83' SW COR GPCO BOX @ TOP

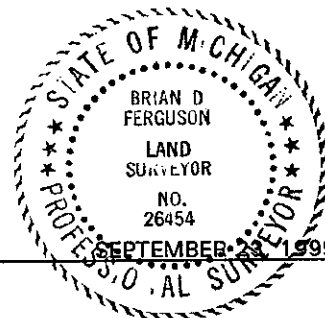

Signed by Brian D Ferguson
Surveyor's Michigan License No. 26454

Date SEPTEMBER 23 1999