

APPROVED BY PEER GROUP
P.A. 345 OF 1990
SAGINAW COUNTY

[Handwritten Signature]

SAGINAW COUNTY REMONUMENTATION

RECORDED/FILED

LAND CORNER RECORDATION CERTIFICATE

Filing Requirement of Act 74, Mich. P.A. 1970

1999 SEP 29 A 8:05

For corners in

KOCHVILLE TOWNSHIP

<u>SAGINAW</u> (County)	Located in:	Corner Code #
1. Public Land Survey	T13 N R 4 E	F-9
	T _____ R _____	_____
2. Property Controlling in Section	S _____ T _____ R _____	_____
	S _____ T _____ R _____	_____
3. Miscellaneous Property in Sec.	S _____ T _____ R _____	_____
	S _____ T _____ R _____	_____

MILDRED M. DODAK
REGISTER OF DEEDS
SAGINAW COUNTY, MI.

LIBER 2144 PAGE 759

Lib 8 Page 24

Register of Deeds Stamp & File Number

- 4. Lot No. _____, Recorded Plat _____
- 5. Private Claims _____

I, Brian D Ferguson, in a field survey on JUNE 28, 19 99 do hereby state that under requirements of P.A. 74, Michigan P.A. of 1970, the corner points mentioned in lines 1 and 2 above were in conformance with regulations and rules therefore as required in the current manual of survey instructions of the United States Department of the Interior, Bureau of Land Management or by a decree of a Court of Law and/or that the corner points mentioned in lines 3, 4 and 5 above were in conformance with the rules of the Michigan Board of Land Surveyors or by a Decree of a Court of Law; established, re-established, monumented, recovered, found as expressed below:

1	A	B	C	D	E	F	G	H	I	J	K	L	M
2		6		5		4		3		2		1	
3													
4		7		8		9		10		11		12	
5													
6		18		17		16		15		14		13	
7													
8		19		20		21		22		23		24	
9													
10		30		29		28		27		26		25	
11													
12		31		32		33		34		35		36	
13													

NOTE: Not more than 2 corners, all in the same town and range, may be recorded on this certificate.

A. Description of original monument and accessories and/or subsequent restoration:

F-9 WOOD POST SET BY J. WAMPLER IN 1822, NO EVIDENCE OF ORIGINAL CORNER REMAINS
LCRC BY EUGENE GOSS IN 1972, L 2, PG 78
SURVEY RECORDED IN L 1366, PG 61

RECORDED &
FILED

SEP 29 2000

SECTION

B. Description of corner evidence found and/or method applied in restoring or reestablishing corner:

F-9 FOUND 3/4" PIPE IN MONUMENT BOX
LCRC AND SURVEY CALL FOR PK NAIL. RECORDED WITNESSES FROM LCRC AND SURVEY AGREE WITH LOCATION OF 3/4" PIPE

ACCEPTED BY PEER GROUP AS THE BEST AVAILABLE EVIDENCE OF THE POSITION OF THE ORIGINAL CORNER

C. Description of monument for corner and accessories established to perpetuate locating the position of the corner:

F-9 SET 5/8" REBAR W/ 3" BRASS CAP IN MONUMENT BOX
N10W 11.56' NAIL E FCE PWR POLE
S35W 40.50' FCE TELE/PWR POLE
S50E 29.00' REBAR N SIDE OF DITCH
N45E 30.57' REBAR EDGE OF BEAN FIELD

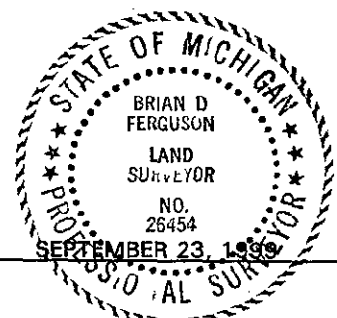

Signed by Brian D Ferguson
Surveyor's Michigan License No. 26454

Date _____