

REMONUMENTATION

NOV 21 1997

LIBER

2 PAGE 118

REMONUMENTATION

COMMISSION

LAND CORNER RECORDATION CERTIFICATE  
Filing Requirement of Act 74, Mich. P.A. 1970

RECEIVED FOR RECORD

97 SEP -9 AM 8:56

LIBER NO. 2 PAGE NO. 118  
ESTHER LEE  
REGISTER OF DEEDS  
SANILAC CO., MICHIGAN

For corners in

Sanilac (County)	Located in:	Corner Code #
1. Public Land Survey	T10N R12E	A - 1
	T R	
	T R	
	T R	Seg #2
2. Property Controlling in Section	S T R	
	S T R	
3. Miscellaneous Property in Sec.	S T R	
	S T R	

Register of Deeds Stamp & File Number

4. Lot No. \_\_\_\_\_, Recorded Plat \_\_\_\_\_  
5. Private Claims \_\_\_\_\_

I, John A Milletics, in a field survey on May 15, 1997 do hereby state that under requirements of P.A. 74, Michigan P.A. of 1970, the corner points mentioned in lines 1 and 2 above were in conformance with regulations and rules therefore as required in the current manual of survey instructions of the United States Department of the Interior, Bureau of Land Management or by a decree of a Court of Law and /or that the corner points mentioned in lines 3, 4 and 5 above were in conformance with the rules of the Michigan Board of Land Surveyors or by a Decree of a Court of Law; established, re-established, monumented, recovered, found as expressed below:

NOTE: Not more than 2 corners, all in the same town and range, may be recorded on this certificate.

	A	B	C	D	E	F	G	H	I	J	K	L	M
1													
2	6		5		4		3		2		1		
3													
4	7		8		9		10		11		12		
5													
6	10		17		16		15		14		13		
7													
8	19		20		21		22		23		24		
9													
10	30		29		28		27		26		25		
11													
12	31		32		33		34		35		36		
13													

A. Description of original monument and accessories and/or subsequent restoration:

- A - 1
- GLO Notes
- Beech 10 S23E 34 1/2
- Beech 10 S27W 27

APPROVED PEER BOARD MEETING  
Aug 18, 1997 JM

B. Description of corner evidence found and/or method applied in restoring or reestablishing corner:

- A - 1
- Found Monu Box - removed by Sanilac County Road Comm. during reconstruction of Road, REPLACED using Act 74 recorded Liber 1 Page 382

C. Description of monument for corner and accessories established to perpetuate locating the position of the corner:

- A - 1
- NW Corner Section 6 T10N-R12E
- Moun Box with iron and cap
- S45°E 50.50' to a nail in a Power Pole
- S35°W 99.00' to a nail in a Power Pole
- N20°W 16.85' to a nail in a Guard Rail Post
- N05°E 20.90' to the West leg of a Road Sign
- N70°W 76.78' to a Road Sign
- S40°E 54.25' to a Road Sign
- East 2829.72' to the N 1/4 Cor Section 6

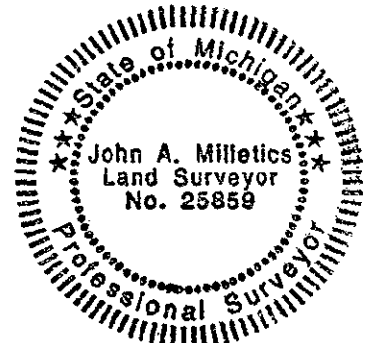

Signed by [Signature]  
Surveyor's Michigan License No. 25859

Date Aug 11, 97