

NOV 19 1993 LAND CORNER RECORDATION CERTIFICATE

FILING REQUIREMENT OF ACT 74, MICH. P.A.1970

COMMISSION

FOR CORNERS OF--:	LOCATED IN--:	CORNER CODE NUMBER
1. PUBLIC LAND SURVEY _____	T. 10 <input checked="" type="checkbox"/> N. <input checked="" type="checkbox"/> R. 12 <input checked="" type="checkbox"/> E.	E - 1, <u>D - 1</u>
2. PROPERTY CONTROLLING IN SECTION _____	T. _____ S. _____ R. _____ E. _____ W. _____	<u>Seg. 1</u>
3. MISCELLANEOUS PROPERTY IN SECTION _____	T. _____ S. _____ R. _____ E. _____ W. _____	
4. LOT NO. _____, RECORDED PLAT _____		
5. PRIVATE CLAIMS _____		

RECEIVED FOR RECORD
 93 NOV -4 AM 11:57
 LIDER NO. 1 PAGE NO. 385
 ESTHER LEE
 REGISTER OF DEEDS
 SANILAC CO., MICHIGAN
 REGISTER OF DEEDS STAMP AND FILING NUMBER

I, John A Milletics, do hereby certify that under requirements of P.A. 74, Michigan P.A. of 1970, the corner points mentioned in lines 1 and 2 above were, in a field survey on July 6, 1993, established, re-established, monumented, re-monumented, recovered or restored as expressed below and in conformance with regulations and rules therefore as required in the current manual of survey instructions of the United States Department of the Interior, Bureau of Land Management or by a decree of a court of law. Furthermore, that the corner points mentioned in lines 3, 4 and 5 above were, in a field survey on _____, 19____, found, recovered, restored, established or re-established as expressed below and in conformance with the rules of the Michigan State Board of Registration for Land Surveyors or, by a Decree of a Court of law:

A. Description of original monument and accessories and/or subsequent restoration:

- E - 1 Found Monu box centerline M-53 and the Marlette Road, Corner is recorded in numerous Plats in the city of Marlette.
- D - 1 Found Monu Box in place, Corner is recorded in numerous Plats in the City of Marlette.

B. Description of corner evidence found and/or method applied in restoring or re-establishing corner:

- | | |
|----------------------------|-------------------------------|
| E - 1 | D - 1 |
| NE Cor Section 5 T10N-R12E | N 1/4 Cor Section 5 T10N-R12E |
| Found Monu. Box | Found Monu. Box |

C. Description of monument for corner and accessories established to perpetuate locating the position of the corner:

- | | |
|---------------------------------|--|
| E - 1 | D - 1 |
| NE Cor Section 5 T10N-R12E | N 1/4 Cor Section 5 T10N-R12E |
| Monu Box in place | Monu Box in place |
| N55°E 79.27' to SW Cor of Bldg. | N60°E 50.84' to a nail in a Power Pole |
| S40°E 49.20' to NW Cor of Bldg. | S20°E 68.41' to the NW Cor of a House |
| S50°W 51.53' to NE Cor of Bldg. | S10°W 36.30' to a nail in a Power Pole |

SIGNED BY John A Milletics DATE Nov 1, 1993

SURVEYOR'S MICHIGAN REGISTRATION NO. 25859

FOR STATE AND UNITED STATES AGENCIES:

SIGNED BY _____ DATE _____

CHIEF OF SURVEY PARTY

APPROVED AND SIGNED BY _____ DATE _____

MICHIGAN REGISTERED LAND SURVEYOR

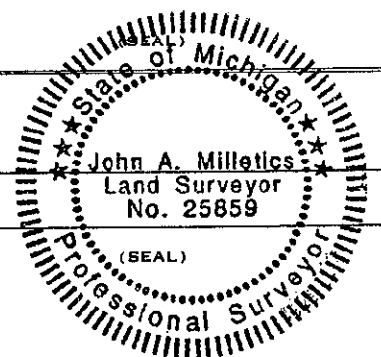

SURVEYOR'S MICHIGAN REGISTRATION NO. _____