

94 DEC 16 AM 9:41

LAND CORNER RECORDATION CERTIFICATE  
Filing Requirement of Act 74, Mich. P.A. 1970

LIBER NO. 2 PAGE NO. 16  
ESTHER LEE  
REGISTER OF DEEDS  
SANILAC CO., MICHIGAN

REMONUMENTATION  
SURVEY &  
REMONUMENTATION  
APR 10 1995  
COMMISSION

For corners in \_\_\_\_\_  
San \_\_\_\_\_ (County) Located In: \_\_\_\_\_ Corner Code # \_\_\_\_\_

1. Public Land Survey T 10 N R 13 E A - 5  
T \_\_\_\_\_ R \_\_\_\_\_  
T \_\_\_\_\_ R \_\_\_\_\_  
T \_\_\_\_\_ R \_\_\_\_\_

2. Property Controlling S \_\_\_\_\_ T \_\_\_\_\_ R \_\_\_\_\_  
in Section S \_\_\_\_\_ T \_\_\_\_\_ R \_\_\_\_\_

3. Miscellaneous S \_\_\_\_\_ T \_\_\_\_\_ R \_\_\_\_\_  
Property in Sec. S \_\_\_\_\_ T \_\_\_\_\_ R \_\_\_\_\_

4. Lot No. \_\_\_\_\_, Recorded Plat \_\_\_\_\_

5. Private Claims \_\_\_\_\_

Register of Deeds Stamp & File Number

	A	B	C	D	E	F	G	H	I	J	K	L	A
2	6	5	4	3	2	1							
3													
4	7	8	9	10	11	12							
5													
6	13	17	16	15	14	13							
7													
8	19	20	21	22	23	24							
9													
10	30	29	28	27	26	25							
11													
12	31	32	33	34	35	36							
13													

I, John A Milletics in a field survey on Aug 15 1994 do hereby certify that under requirements of P.A. 74, Michigan P.A. of 1970, the corner points mentioned in lines 1 and 2 above were in conformance with regulations and rules therefore as required in the current manual of survey instructions of the United States Department of the Interior, Bureau of Land Management or by a decree of a Court of Law and/or that the corner points mentioned in lines 3, 4 and 5 above were in conformance with the rules of the Michigan Board of Land Surveyors or by a Decree of a Court of Law; established, re-established, monumented, re-monumented, recovered, found as expressed below:

NOTE: Not more than 4 corners, all in the same town and range, may be recorded on this certificate.

A. Description of original monument and accessories and/or subsequent restoration:

A - 5 GLO Notes  
Set Post Tamk 5 S 36 W 30, Ash 5 N 40 W 43

Act 74 Forms Liber 1, Page 163

Act 132 Forms Liber 4 Page 204, Liber 2 Page 514, Liber 2 Page 515

Road Comm NONE

Drain Comm NONE

Approved Peer Board Meeting  
Dec. 16, 1994 gm

B. Description of corner evidence found and/or method applied in restoring or reestablishing corner:

A - 5  
NW Cor Section 18 T10N-R13E  
Found 1/2" Iron bar

C. Description of monument for corner and accessories established to perpetuate locating the position of the corner:

A - 5  
NW Cor Section 18, T10N-R13E  
Found 1/2" Iron Bar  
West 16.25' to a nail in a Fence Post  
West 65.00' to a nail in a 18" ASH  
S30°W 32.50' to a nail in a Fence Post  
N20°E 46.00' to a nail in a 18" ASH

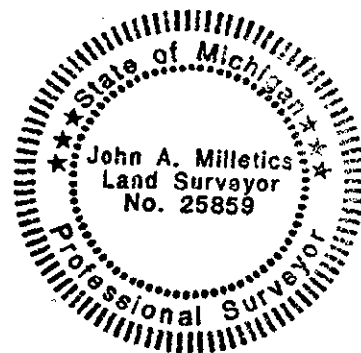

Signed by John A. Milletics Date Dec 5, 1994  
Surveyor's Michigan License No. 25859