

REMONUMENTATION SURVEY & REMONUMENTATION
 APR 10 1995
 COMMISSION

LIBER

2 PAGE 24

RECEIVED FOR RECORD

94 DEC 16 AM 9:41

LAND CORNER RECORDATION CERTIFICATE

Filing Requirement of Act 74, Mich. P.A. 1970

LIBER NO. 2 PAGE NO. 24
 ESTHER LEE
 REGISTER OF DEEDS
 SANILAC CO., MICHIGAN

For corners in
 Sanilac

(County)

Located In:

Corner Code #

1. Public Land Survey T 10 NR 13 E A - 13
 T R
 T R
 T R
2. Property Controlling S T R
 in Section S T R
3. Miscellaneous S T R
 Property in Sec. S T R

Register of Deeds Stamp & File Number

4. Lot No. _____, Recorded Plat _____
 5. Private Claims _____

I, John A Milletics, in a field survey on Sept 6, 19 94, do hereby certify that under requirements of P.A. 74, Michigan P.A. of 1970, the corner points mentioned in lines 1 and 2 above were in conformance with regulations and rules therefore as required in the current manual of survey instructions of the United States Department of the Interior, Bureau of Land Management or by a decree of a Court of Law and/or that the corner points mentioned in lines 3, 4 and 5 above were in conformance with the rules of the Michigan Board of Land Surveyors or by a Decree of a Court of Law; established, re-established, monumented, re-monumented, recovered, found as expressed below:

NOTE: Not more than 4 corners, all in the same town and range, may be recorded on this certificate.

A. Description of original monument and accessories and/or subsequent restoration:

A - 13 GLO Notes
 Set Post Hemlock 16 S 6 E .37, Hemlock N 39 E .29
 Act 74 Forms NONE
 Act 132 Forms Liber 4 Page 175

Road Comm. None
 Drain Comm. None

	A	B	C	D	E	F	G	H	I	J	K	L	M
2	6	5	4	3	2								
3													
4	7	8	9	10	11	12							
5													
6	18	17	16	15	14	13							
7													
8	19	20	21	22	23	24							
9													
10	30	29	28	27	26	25							
11													
12	31	32	33	34	35	36							
13													

Approved Peer Board Meeting
 Dec. 16, 1994 *jm*

B. Description of corner evidence found and/or method applied in restoring or reestablishing corner:

A - 13
 SW Cor Section 31 T10N-R13E
 Found 1/2" Iron with Brass Disk #23510 M - 13 Lapeer Co.

C. Description of monument for corner and accessories established to perpetuate locating the position of the corner:

A - 13
 SW Cor Section 31 T10N-R13E
 Found 1/2" iron with Brass Disk #23510
 N55°W 38.06' to a nail in a GTE Pole
 N47°E 34.98' to a nail in a Fence Post
 N82°E 86.25' to a nail in a Power Pole

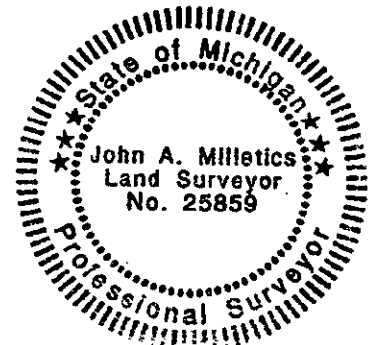

Signed by *John A Milletics*

Date Dec 5, 1994

Surveyor's Michigan License No. 25859