

NOV 19 1993

LAND CORNER RECORDATION CERTIFICATE

FILING REQUIREMENT OF ACT 74, MICH. P.A.1970

COMMISSION

FOR CORNERS OF--:	LOCATED IN--:	CORNER CODE NUMBER
1. PUBLIC LAND SURVEY_____	T. 10 N. R. 13 E.	B - 1, C - 1
2. PROPERTY CONTROLLING IN SECTION_____	T. _____ N. S., R. _____ E. W.	_____
3. MISCELLANEOUS PROPERTY IN SECTION_____	T. _____ N. S., R. _____ E. W.	_____
4. LOT NO. _____, RECORDED PLAT _____		
5. PRIVATE CLAIMS _____		

RECEIVED FOR RECORD

93 NOV -4 AM 11:54

LIBER NO. 1 PAGE NO. 378
ESTHER LEE
REGISTER OF DEEDS
SANILAC CO., MICHIGAN

REGISTER OF DEEDS STAMP AND FILING NUMBER

I, John A Milletics, do hereby certify that under requirements of P.A. 74, Michigan P.A. of 1970, the corner points mentioned in lines 1 and 2 above were, in a field survey on July 12, 1993, established, re-established, monumented, re-monumented, recovered or restored as expressed below and in conformance with regulations and rules therefore as required in the current manual of survey instructions of the United States Department of the Interior, Bureau of Land Management or by a decree of a court of law. Furthermore, that the corner points mentioned in lines 3, 4 and 5 above were, in a field survey on _____, 19____, found, recovered, restored, established or re-established as expressed below and in conformance with the rules of the Michigan State Board of Registration for Land Surveyors or, by a Decree of a Court of law:

A. Description of original monument and accessories and/or subsequent restoration:

- B - 1 Found R/R Spike in Blacktop as recorded in Liber 4 Page 501 of the Sanilac County Records
- C - 1 Found P.K. nail in Blacktop as recorded in Liber 4 Page 76 of the Sanilac County Records.

B. Description of corner evidence found and/or method applied in restoring or re-establishing corner:

- | | |
|-------------------------------|----------------------------|
| B - 1 | C - 1 |
| N 1/4 Cor Section 6 T10N-R13E | NE Cor Section 6 T10N-R13E |
| Found R/R spike | Found P.K. nail |

C. Description of monument for corner and accessories established to perpetuate locating the position of the corner:

- | | |
|---|--|
| B - 1 | C - 1 |
| N 1/4 Cor Section 6 T10N-R13E | NE Cor Section 6 T10N-R13E |
| Monu Box Set | Monu Box Set |
| West 13.00' to the S 1/4 Cor Sec 36 T11N-R12E | West 10.88' to the SW Cor Section 31 T11N-R13E |
| N45°W 142.90' to a nail in a Power Pole | North 56.8' to a nail in a Power Pole |
| South 51.65' to a nail in a Double Poplar | N45°W 78.23' to a nail in a Power Pole |
| | S45°W 68.90' to a nail in a 24" Poplar |

SIGNED BY [Signature] DATE Nov 4, 1993

SURVEYOR'S MICHIGAN REGISTRATION NO. 25859

FOR STATE AND UNITED STATES AGENCIES:

SIGNED BY _____ DATE _____

CHIEF OF SURVEY PARTY

APPROVED AND SIGNED BY _____ DATE _____

MICHIGAN REGISTERED LAND SURVEYOR

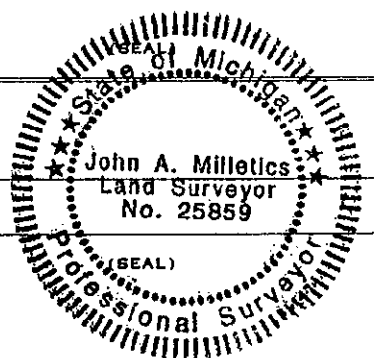

SURVEYOR'S MICHIGAN REGISTRATION NO. _____