

RECEIVED FOR RECORD

94 DEC 16 AM 9:40

LIBER NO. 2 PAGE NO. 7  
ESTHER LEE  
REGISTER OF DEEDS  
SANILAC CO., MICHIGAN

REMONUMENTATION LAND CORNER RECORDATION CERTIFICATE  
Filing Requirement of Act 74, Mich. P.A. 1970

For corners in Sanilac (County) Located In: \_\_\_\_\_ Corner Code # \_\_\_\_\_

1. Public Land Survey T 10N R 13E H - 13  
 \_\_\_\_\_ R \_\_\_\_\_  
 \_\_\_\_\_ T \_\_\_\_\_  
 \_\_\_\_\_ T \_\_\_\_\_

2. Property Controlling S \_\_\_\_\_ T \_\_\_\_\_ R \_\_\_\_\_  
 in Section S \_\_\_\_\_ T \_\_\_\_\_ R \_\_\_\_\_

3. Miscellaneous S \_\_\_\_\_ T \_\_\_\_\_ R \_\_\_\_\_  
 Property in Sec. S \_\_\_\_\_ T \_\_\_\_\_ R \_\_\_\_\_

4. Lot No. \_\_\_\_\_, Recorded Plat \_\_\_\_\_

5. Private Claims \_\_\_\_\_

SURVEY & REMONUMENTATION  
APR 10 1995  
COMMISSION

Register of Deeds Stamp & File Number

I, John A Milletics in a field survey on Dec 2, 19 94, do hereby certify that under requirements of P.A. 74, Michigan P.A. of 1970, the corner points mentioned in lines 1 and 2 above were in conformance with regulations and rules therefore as required in the current manual of survey instructions of the United States Department of the Interior, Bureau of Land Management or by a decree of a Court of Law and/or that the corner points mentioned in lines 3, 4 and 5 above were in conformance with the rules of the Michigan Board of Land Surveyors or by a Decree of a Court of Law; established, re-established, monumented, re-monumented, recovered, found as expressed below:

NOTE: Not more than 4 corners, all in the same town and range, may be recorded on this certificate.

A. Description of original monument and accessories and/or subsequent restoration:  
H - 13 GLO Notes  
Set 1/2 Mile Post Hemlock 8 N65W 25, Sugar 9 N76E 24 1/2  
Act 74 Form None  
Act 132 Form Liber 4, Page 274, Liber 3 Page 88, Liber 3 Page 226  
Unrecorded survey - Galbraith dated 4 - 17 - 1889  
Road Comm None  
Drain Comm None

Approved Peer Board Meeting  
Dec. 16, 1994 gm

	A	B	C	D	E	F	G	H	I	J	K	L	M
2	6	5	4	3	2	1							
3													
4	7	8	9	10	11	12							
5													
6	18	17	16	15	14	13							
7													
8	19	20	21	22	23	24							
9													
10	30	29	28	27	26	25							
11													
12	31	32	33	34	35	36							
13													

B. Description of corner evidence found and/or method applied in restoring or reestablishing corner:  
H - 13  
S 1/4 Corner Section 34 T10N-R13E  
Found 1/2" Iron Bar

C. Description of monument for corner and accessories established to perpetuate locating the position of the corner:  
H - 13  
S 1/4 Cor Section 34 T10N-R13E  
Found 1/2" Iron Bar  
East 15.17' to a 1 1/2" Square Iron Bar in Road Bed  
S15°E 25.20' to a nail in a Wooden Fence Post  
N60°E 101.08' to a nail in a Large Power Pole  
N70°W 160.90' to a nail in a Large Power Pole

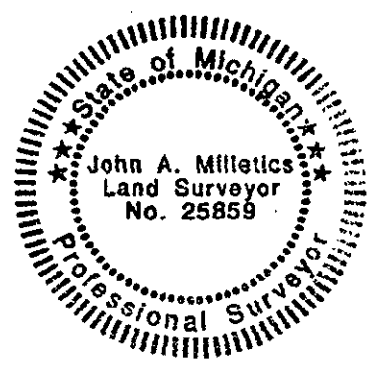

Signed by John A. Milletics Date Dec 6, 1994  
Surveyor's Michigan License No. 25859