

SURVEY & REMONUMENTATION

LIBER

2 PAGE 8

RECEIVED FOR RECORD

94 DEC 16 AM 9:40

REMONUMENTATION

LAND CORNER RECORDATION CERTIFICATE

Filing Requirement of Act 74, Mich. P.A. 1970

For corners in Sanilac

(County)

Located In:

Corner Code #

LIBER NO. 2 PAGE NO. 8
ESTHER LEE
REGISTER OF DEEDS
SANILAC CO., MICHIGAN

- 1. Public Land Survey. T 10 NR 13E I - 13
T R
T R
T R
- 2. Property Controlling in Section S T R
S T R
- 3. Miscellaneous Property in Sec. S T R
S T R
- 4. Lot No. , Recorded Plat
- 5. Private Claims

Register of Deeds Stamp & File Number

I, John A Milletics in a field survey on Dec 2, 1994, do hereby certify that under requirements of P.A. 74, Michigan P.A. of 1970, the corner points mentioned in lines 1 and 2 above were in conformance with regulations and rules therefore as required in the current manual of survey instructions of the United States Department of the Interior, Bureau of Land Management or by a decree of a Court of Law and/or that the corner points mentioned in lines 3, 4 and 5 above were in conformance with the rules of the Michigan Board of Land Surveyors or by a Decree of a Court of Law; established, re-established, monumented, re-monumented, recovered, found as expressed below:

NOTE: Not more than 4 corners, all in the same town and range, may be recorded on this certificate.

	A	B	C	D	E	F	G	H	I	J	K	L	M
2	6	5	4	3	2	1							
3													
4	7	8	9	10	11	12							
5													
6	18	17	16	15	14	13							
7													
8	19	20	21	22	23	24							
9													
10	30	29	28	27	26	25							
11													
12	31	32	33	34	35	36							
13													

A. Description of original monument and accessories and/or subsequent restoration:

I - 13 GLO Notes
 Set Post Corner Sugar 18 N68W 26, Hemlock 8 N66E 20 1/2
 Act 74 Form NONE
 Act 132 Form Liber 4 Page 274, Liber 3 Page 226
 Unrecorded Surey Dated 3-5-91, Galbraith Survey dated 4-17-1889

Road Comm NONE
 Drain Comm NONE

Approved Peer Board Meeting
Dec. 16, 1994 97

B. Description of corner evidence found and/or method applied in restoring or reestablishing corner:

I - 13
 SE Corner Section 34 T10N-R13E
 Found 5/8" Iron bar in Road Bed

C. Description of monument for corner and accessories established to perpetuate locating the position of the corner:

I - 13
 SE Corner Section 34 T10N-R13E
 Found 5/8" Iron bar
 N45°W 61.70 to a nail in a Riser Pole
 N45°E 55.39 to a nail in a Power Pole
 S45°E 61.28 to a Tele Box
 S45°W 61.00 to a nail in a Wooden Fence Post
 East 17.72' to a R/R sipke in the Blacktop

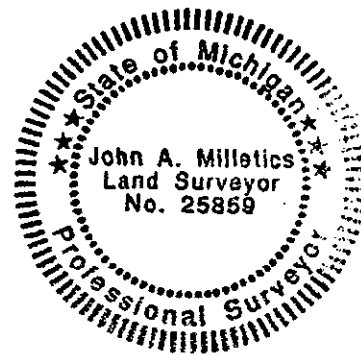

Signed by John A. Milletics

Date Dec 8, 1994

Surveyor's Michigan License No. 25859