

LAND CORNER RECORDATION CERTIFICATE

Filing Requirement of Act 74, Mich. P.A. 1970

RECEIVED FOR RECORD

95 JUL 10 AM 9:26

LIBER NO. 2 PAGE NO. 53  
ESTHER LEE  
REGISTER OF DEEDS  
SANILAC CO., MICHIGAN

Register of Deeds Stamp & File Number

Remonumentation

For corners in

Sanilac  
(County)

Located In:

Corner Code #

1. Public Land Survey	T	10N	R	13E	J-5	K-5
	T		R			
	T		R			
	T		R			
2. Property Controlling in Section	S		T	R		
	S		T	R		
3. Miscellaneous Property in Sec.	S		T	R		
	S		T	R		

- 4. Lot No. \_\_\_\_\_, Recorded Plat \_\_\_\_\_
- 5. Private Claims \_\_\_\_\_

	A	B	C	D	E	F	G	H	I	J	K	L	M
2	6	5	4	3	2	1							
3													
4	7	8	9	10	11	12							
5													
6	18	17	16	15	14	13							
7													
8	19	20	21	22	23	24							
9													
10	30	29	28	27	26	25							
11													
12	31	32	33	34	35	36							
13													

I, John A Milletics, in a field survey on April 12, 19 95, do hereby certify that under requirements of P.A. 74, Michigan P.A. of 1970, the corner points mentioned in lines 1 and 2 above were in conformance with regulations and rules therefore as required in the current manual of survey instructions of the United States Department of the Interior, Bureau of Land Management or by a decree of a Court of Law and/or that the corner points mentioned in lines 3, 4 and 5 above were in conformance with the rules of the Michigan Board of Land Surveyors or by a Decree of a Court of Law; established, re-established, monumented, re-monumented, recovered, found as expressed below:

**NOTE: Not more than 4 corners, all in the same town and range, may be recorded on this certificate.**

**A. Description of original monument and accessories and/or subsequent restoration:**

J-5 GLO Notes

Set Post Hemloch 10 S45E 10, Beech 10 N41W 49  
Act 74 Form None, Old Survey Liber page 38 June 1894, Act 132 Form None  
Unrecorded survey I.E. Choep 1970

K-5 GLO Notes

Set Post Tamarach 10 S65°W 19, Tamarach 10 N80°E 29  
Act 74 Form None, Old Survey liber page 38 June 1894  
Act 132 Form None, Road Comm None, Drain Comm None

Approved Peer Group Meeting May 25, 1995

*JM*

**B. Description of corner evidence found and/or method applied in restoring or reestablishing corner:**

J-5  
S 1/4 Cor Section 11 T10N-R13E  
Found 1/2" Iron Bar

K-5  
SE Cor Section 11 T10N-R13E  
Found 1" Spike in gravel road bed

SURVEY & REMONUMENTATION

JUL 31 1995

COMMISSION

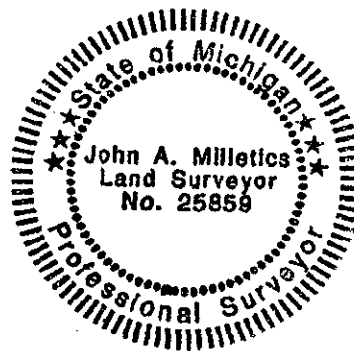

**C. Description of monument for corner and accessories established to perpetuate locating the position of the corner:**

J-5  
S 1/4 Section 11 T10N-R13E  
1/2" Iron Bar  
S45°W 78.0 to a nail in a Power Pole  
S45°W 47.8 to the NE Cor of a Bell Box  
North 26.1 to a nail in a 24" Catalpa  
S45°E 43.8 to a nail in a Bell Pole

K-5  
SE Cor Section 11 T10N-R13E  
1" spike  
N05°E 18.9 to a nail in a guard rail post  
N50°E 27.4 to a nail in a guard rail post  
N70°E 43.4 to a nail in a guard rail post  
S45°E 80.5 to a nail in a Power Pole

Signed by John A. Milletics

Date May 23, 1995

Surveyor's Michigan License No. 25859