

LAND CORNER RECORDATION CERTIFICATE
Filing Requirement of Act 74, Mich. P.A. 1970

RECEIVED FOR RECORD

95 JUL 10 AM 9:27

LIBER NO. 2 PAGE NO. 54
 ESTHER LEE
 REGISTER OF DEEDS
 SANILAC CO., MICHIGAN

Remonumentation

For corners in

Sanilac
 (County)

Located In:

Corner Code #

- | | | |
|---------------------------------------|---------------------------|------------|
| 1. Public Land Survey | T <u>10N</u> R <u>13E</u> | <u>L-5</u> |
| | T _____ R _____ | _____ |
| | T _____ R _____ | _____ |
| | T _____ R _____ | _____ |
| 2. Property Controlling in Section | S _____ T _____ R _____ | _____ |
| | S _____ T _____ R _____ | _____ |
| 3. Miscellaneous Property in Sec. | S _____ T _____ R _____ | _____ |
| | S _____ T _____ R _____ | _____ |
| 4. Lot No. _____, Recorded Plat _____ | | |
| 5. Private Claims _____ | | |

Register of Deeds Stamp & File Number

I, John A Milletics, in a field survey on April 12, 1995, do hereby certify that under requirements of P.A. 74, Michigan P.A. of 1970, the corner points mentioned in lines 1 and 2 above were in conformance with regulations and rules therefore as required in the current manual of survey instructions of the United States Department of the Interior, Bureau of Land Management or by a decree of a Court of Law and/or that the corner points mentioned in lines 3, 4 and 5 above were in conformance with the rules of the Michigan Board of Land Surveyors or by a Decree of a Court of Law; established, re-established, monumented, re-monumented, recovered, found as expressed below:

	A	B	C	D	E	F	G	H	I	J	K	L	M
2	6	5	4	3	2	1							
3													
4	7	8	9	10	11	12							
5													
6	18	17	16	15	14	13							
7													
8	19	20	21	22	23	24							
9													
10	30	29	28	27	26	25							
11													
12	31	32	33	34	35	36							
13													

NOTE: Not more than 4 corners, all in the same town and range, may be recorded on this certificate.

A. Description of original monument and accessories and/or subsequent restoration:
 L-5
 GLO Notes Set 1/4 Post Hemlock 18 S45°E 14, Pine 18 N53°W 8
 Act 74 Form None, Old Survey liber Page 36 May 1891
 Act 132 Form None, Road Comm None, Drain Comm None

Approved Peer Group Meeting May 25, 1995

JM

B. Description of corner evidence found and/or method applied in restoring or reestablishing corner:
 L-5
 S 1/4 Cor Section 12 T10N-R13E
 Found 5/8" smooth Iron Bar in gravel Road Bed
 S15°E 26.0 to a nail in a Fence Post
 S50°W 37.4 to a nail in a 12" Maple
 S55°E 53.5 to a nail in a clump of Ash
 North 22.0 to the west end of a 12" CMP

SURVEY & REMONUMENTATION

JUL 3 1 1995

COMMISSION

C. Description of monument for corner and accessories established to perpetuate locating the position of the corner:
 L-5
 South 1/4 Cor Section 12 T10N-R13E
 5/8" Smooth Iron Bar
 S15°E 26.0 to a nail in a Fence Post
 S50°W 37.4 to a nail in a 12" Maple
 S55°E 53.5 to a nail in a clump of Ash
 North 22.0 to the west end of a 12" CMP

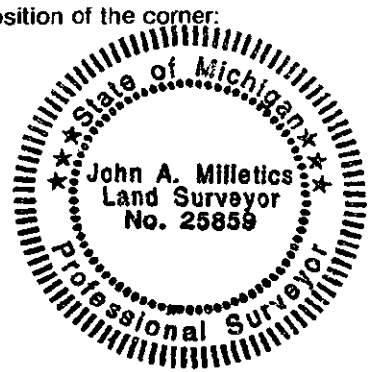

Signed by John A Milletics

Date May 23, 1995

Surveyor's Michigan License No. 25859