

SURVEY & REMONUMENTATION

APR 14 1998

LIBER 2 PAGE 160

REMONUMENTATION SECTION

LAND CORNER RECORDATION CERTIFICATE
Filing Requirement of Act 74, Mich. P.A. 1970

RECEIVED FOR RECORD

97 DEC -2 AM 9:09

LIBER NO. 2 PAGE NO. 160

ESTHER LEE
REGISTER OF DEEDS
SANILAC CO. MICHIGAN

REMONUMENTATION

JAN 08 1998

Register of Deeds Stamp & File Number

For corners in ELK TOWNSHIP

Sanilac (County)	Located In:	Corner Code #
1. Public Land Survey	T10N R14E	C - 11
	T R	
	T R	
	T R	
2. Property Controlling in Section	S T R	
	S T R	
3. Miscellaneous Property in Sec.	S T R	
	S T R	

4. Lot No. _____, Recorded Plat _____
5. Private Claims _____

I, John A Milletics, in a field survey on June 29, 1997 do hereby state that under requirements of P.A. 74, Michigan P.A. of 1970, the corner points mentioned in lines 1 and 2 above were in conformance with regulations and rules therefore as required in the current manual of survey instructions of the United States Department of the Interior, Bureau of Land Management or by a decree of a Court of Law and/or that the corner points mentioned in lines 3, 4 and 5 above were in conformance with the rules of the Michigan Board of Land Surveyors or by a Decree of a Court of Law; established, re-established, monumented, recovered, found as expressed below.

NOTE: Not more than 2 corners, all in the same town and range, may be recorded on this certificate.

	A	B	C	D	E	F	G	H	I	J	K	L	M
1													
2	6	5	4	3	2	1							
3													
4	7	8	9	10	11	12							
5													
6	18	17	16	15	14	13							
7													
8	19	20	21	22	23	24							
9													
10	30	29	28	27	26	25							
11													
12	31	32	33	34	35	36							
13													

A. Description of original monument and accessories and/or subsequent restoration:

C - 11
GLO Notes
Set Post Corner
B. Ash 20 S84°W 16
Elm 7 S84°E 22
No Old Survey Liber
No Act 74
Unrecorded survey dated 4-2-91
Act 132 Liber 1 Page 423

B. Description of corner evidence found and/or method applied in restoring or reestablishing corner:

C - 11
Found 5/8 Iron Bar in Monu Box

APPROVED PEER BOARD MEETING
NOV. 26, 1997

C. Description of monument for corner and accessories established to perpetuate locating the position of the corner:

C - 11
Monu Box in place with iron bar
N45°E 71.95 feet to a nail in a Power Pole
S45°E 84.08 feet to a nail in a Power Pole
N45°W 93.18 feet to a nail in a Power Pole
N30°W 41.71 feet to a stop sign
S30°E 52.12 feet to a stop sign
East 2629.88 feet to the S 1/4 Cor.

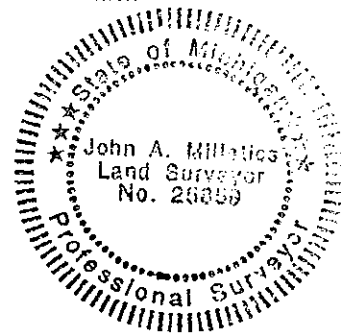

Signed by John A. Milletics
Surveyor's Michigan License No. 25859

Date Nov 12, 1997