

Remonumentation

LAND CORNER RECORDATION CERTIFICATE
Filing Requirement of Act 74, Mich. P.A. 1970

RECEIVED FOR RECORD

95 JUL 10 AM 9:26

LIBER NO. 2 PAGE NO. 49

ESTHER LEE
REGISTER OF DEEDS
SANILAC CO., MICHIGAN

For corners in

Sanilac
(County)

Located In:

Corner Code #

1. Public Land Survey	T 10N R 14E	E-5	F-5
	T _____ R _____		
	T _____ R _____		
	T _____ R _____		
2. Property Controlling in Section	S _____ T _____ R _____		
	S _____ T _____ R _____		
3. Miscellaneous Property in Sec.	S _____ T _____ R _____		
	S _____ T _____ R _____		

Register of Deeds Stamp & File Number

4. Lot No. _____, Recorded Plat _____
5. Private Claims _____

	A	B	C	D	E	F	G	H	I	J	K	L	M
2	6	5	4	3	2	1							
3													
4	7	8	9	10	11	12							
5													
6	18	17	16	15	14	13							
7													
8	19	20	21	22	23	24							
9													
10	30	29	28	27	26	25							
11													
12	31	32	33	34	35	36							
13													

John A Milletics, in a field survey on April 14, 1995, do hereby certify that under requirements of P.A. 74, Michigan P.A. of 1970, the corner points mentioned in lines 1 and 2 above were in conformance with regulations and rules therefore as required in the current manual of survey instructions of the United States Department of the Interior, Bureau of Land Management or by a decree of a Court of Law and/or that the corner points mentioned in lines 3, 4 and 5 above were in conformance with the rules of the Michigan Board of Land Surveyors or by a Decree of a Court of Law; established, re-established, monumented, re-monumented, recovered, found as expressed below:

NOTE: Not more than 4 corners, all in the same town and range, may be recorded on this certificate.

A. Description of original monument and accessories and/or subsequent restoration:

E-5 GLO Notes

Set Post Elm 16 N61E 111, Aspen 8 N14W 239

Act 74 Form None, Act 132 Form Liber 4 Page 150, Liber 3 Page 460

Old Survey Liber Page 126 April 1884, Page 134 Nov 1907

F-5 GLO Notes

Set Post at 40.05 Chains Hemlock 16 N26E 17 Birch 15 S61W 45

Act 74 Form None Act 132 Form None, Unrecorded Survey I.E. Choep Feb 1976

Road Comm None, Drain Comm None

Approved Peer Group

Meeting May 25, 1995

B. Description of corner evidence found and/or method applied in restoring or reestablishing corner: Meeting

E-5

SE Cor Section 8 T10N-R14E

Found 1/2" Iron Bar

F-5

S 1/4 Cor Section 9

Found 1" Bar

SURVEY &
REMONUMENTATION

JUL 8 1995

COMMISSION

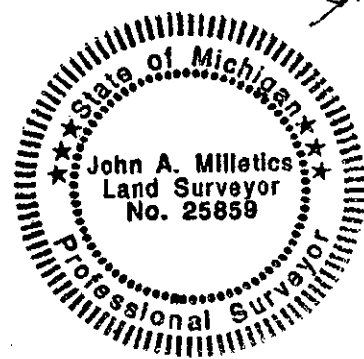

C. Description of monument for corner and accessories established to perpetuate locating the position of the corner:

E-5

SE Cor Section 8 T10N-R14E

1/2" Iron Bar in Road Bed

N40°W 74.5 to a nail in a Power Pole

S05°E 57.7 to a nail in a Power Pole

S30°W 12.9 to the East Leg of a Road Sign

N40°W 38.5 to a Stop Sign

F-5

S 1/4 Cor Section 9 T10N-R14E

1" Iron bar in road bed

S45°E 66.3 to the face of a large rock (5')

N05°E 89.1 to a nail in a Power Pole

N10°E 46.5 to a nail in a Power Pole

N40°E 70.9 to a nail in a 12" Maple

Signed by John A Milletics

Date May 23, 1995

Surveyor's Michigan License No. 25859