

NOV 2 1 1997

LIBER

2 PAGE 128

COMMISSION

REMONUMENTATION

LAND CORNER RECORDATION CERTIFICATE
Filing Requirement of Act 74, Mich. P.A. 1970

RECEIVED FOR RECORD

97 SEP -9 AM 8:57

LIBER NO. 2 PAGE NO. 128
ESTHER LEE
REGISTER OF DEEDS
SANILAC CO. MICHIGAN

For corners in

Sanilac (County)	Located In:	Corner Code #
1. Public Land Survey	T10N R14E	G - 1
	T R	
	T R	
	T R	
	T R	
2. Property Controlling in Section	S T R	
	S T R	
3. Miscellaneous Property in Sec.	S T R	
	S T R	

Register of Deeds Stamp & File Number

4. Lot No. _____, Recorded Plat _____
5. Private Claims _____

	A	B	C	D	E	F	G	H	I	J	K	L	M
1													
2	6		5		4		3		2		1		
3													
4	7		8		9		10		11		12		
5													
6	18		17		16		15		14		13		
7													
8	19		20		21		22		23		24		
9													
10	30		29		28		27		26		25		
11													
12	31		32		33		34		35		36		
13													

I, John A Milletics, in a field survey on June 21, 1997 do hereby state that under requirements of P.A. 74, Michigan P.A. of 1970, the corner points mentioned in lines 1 and 2 above were in conformance with regulations and rules therefore as required in the current manual of survey instructions of the United States Department of the Interior, Bureau of Land Management or by a decree of a Court of Law and for that the corner points mentioned in lines 3, 4 and 5 above were in conformance with the rules of the Michigan Board of Land Surveyors or by a Decree of a Court of Law; established, re-established, monumented, recovered, found as expressed below:

NOTE: Not more than 2 corners, all in the same town and range, may be recorded on this certificate.

A. Description of original monument and accessories and/or subsequent restoration:

GLO Notes

Birch 16 S13W 70
Birch 7 S45½E 38

APPROVED PEER BOARD MEETING
Aug 18, 1997 JM

B. Description of corner evidence found and/or method applied in restoring or reestablishing corner:

G - 1

Found Monu Box - removed by Sanilac County Road Comm, during reconstruction of Road, REPLACED using Act 74 recorded in Liber 1 Page 428

C. Description of monument for corner and accessories established to perpetuate locating the position of the corner:

G - 1

NE Cor Section 4 T10N-R14E

MONU BOX

South 28.60 to the East end of a 12" CMP

S40°W 38.60 to the West end of a 12" CMP

S05°W 74.50 to a nail in a 4" Poplar

South 67.40 to a nail in a 6" Poplar

S05°E 91.90 to a nail in a 10" Ash.

West 2622.24' to the N 1/4 Cor Section 4

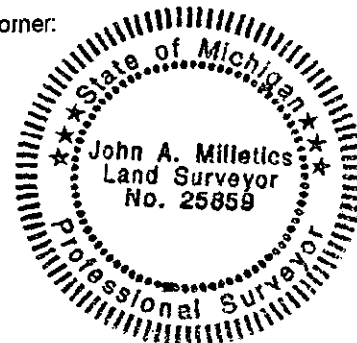

Signed by John A. Milletics
Surveyor's Michigan License No. 25859

Date Aug 15, 1997