

LAND CORNER RECORDATION CERTIFICATE
Filing Requirement of Act 74, Mich. P.A. 1970

Remonumentation

For corners in

Sanilac (County)	Located In:	Corner Code ##
1. Public Land Survey	T 10N R 14E	G-5 H-5
	T ___ R ___	_____
	T ___ R ___	_____
	T ___ R ___	_____
2. Property Controlling in Section	S ___ T ___ R ___	_____
	S ___ T ___ R ___	_____
3. Miscellaneous Property in Sec.	S ___ T ___ R ___	_____
	S ___ T ___ R ___	_____
4. Lot No. _____, Recorded Plat _____		
5. Private Claims _____		

RECEIVED FOR RECORD

95 JUL 10 AM 9:25
SURVEY &
REMONUMENTATION PAGE NO. 48
ESTHER LEE
REGISTER OF DEEDS
SANILAC CO., MICHIGAN
JUL 31 1995
COMMISSION
Register of Deeds Stamp & File Number

John A Milletics in a field survey on April 17, 1995, do hereby certify that under requirements of P.A. 74, Michigan P.A. of 1970, the corner points mentioned in lines 1 and 2 above were in conformance with regulations and rules therefore as required in the current manual of survey instructions of the United States Department of the Interior, Bureau of Land Management or by a decree of a Court of Law and/or that the corner points mentioned in lines 3, 4 and 5 above were in conformance with the rules of the Michigan Board of Land Surveyors or by a Decree of a Court of Law; established, re-established, monumented, re-monumented, recovered, found as expressed below:

	A	B	C	D	E	F	G	H	I	J	K	L	M
2	6	5	4	3	2	1							
3													
4	7	8	9	10	11	12							
5													
6	18	17	16	15	14	13							
7													
8	19	20	21	22	23	24							
9													
10	30	29	28	27	26	25							
11													
12	31	32	33	34	35	36							
13													

NOTE: Not more than 4 corners, all in the same town and range, may be recorded on this certificate.

A. Description of original monument and accessories and/or subsequent restoration:

G-5 GLO Notes

Set Post Maple 20 S17°W 31 Elm 11 N39°E 30

Act 74 Form None, Act 132 Form None, Unrecorded Survey I.E. Chope Feb 1976

Road Comm None, Drain Comm None

H-5 GLO Notes

Set Post at 39.64 Chains B. Ash 11 S10½W 12, Hemlock 7 N37½E 22 "

Act 74 Form None, Act 132 Form None, Unrecorded Surveys Dated Aug 1988, Sept 1983

Road Comm None, Drain Comm None, State Highway Book Page 19

Approved Peer Group Meeting May 25, 1995

B. Description of corner evidence found and/or method applied in restoring or reestablishing corner:

G-5

SE Cor Section 9 T10N-R14E

Found 1" Iron bar in gravel road bed

H-5

S 1/4 Cor Section 10 T10N-R14E

Found Monu Box

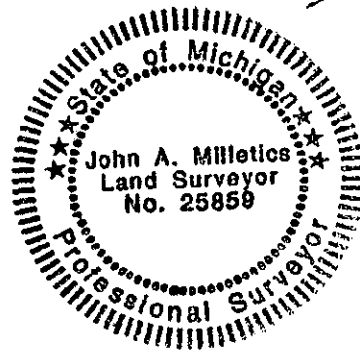

C. Description of monument for corner and accessories established to perpetuate locating the position of the corner:

G-5

SE Cor Section 9 T10N-R14E

1" Spike in gravel road bed

North 48.6 to a nail in a Power Pole

S60°W 37.6 to a nail in a Guardrail Post

N75°W 80.4 to east end of a Headwall

S75°W 80.4 to east end of a Headwall

H-5

S 1/4 Cor Section 10 T10N-R14E

Monu Box

N45°E 66.7 to a nail in a Tele Pole

S45°E 69.8 to a nail in a Power Pole

N45°W 72.3 to a nail in a Power Pole

N55°E 92.6 to a nail in a Power Pole

Signed by John A. Milletics

Date May 23, 1995

Surveyor's Michigan License No. 25859