

REMONUMENTATION

LAND CORNER RECORDATION CERTIFICATE
Filing Requirement of Act 74, Mich. P.A. 1970

94 DEC 16 AM 9:40

For corners in
Sanilac
(County)

SURVEY &
REMONUMENTATION
APR 10 1995
COMMISSION

LIBER NO. 1 PAGE NO. 484
ESTHER LEE
REGISTER OF DEEDS
SANILAC CO., MICHIGAN

Located In:	Corner Code #
1. Public Land Survey T 10N R 14E	K - 13
T R	
T R	
T R	
T R	
2. Property Controlling S T R	
in Section S T R	
3. Miscellaneous S T R	
Property in Sec. S T R	

Register of Deeds Stamp & File Number

- 4. Lot No. _____, Recorded Plat _____
- 5. Private Claims _____

	A	B	C	D	E	F	G	H	I	J	K	L	M
2	6	5	4	3	2	1							
3													
4	7	8	9	10	11	12							
5													
6	18	17	16	15	14	13							
7													
8	19	20	21	22	23	24							
9													
10	30	29	28	27	26	25							
11													
12	31	32	33	34	35	36							
13													

I, John A Milletics, in a field survey on Dec 5, 1994, do hereby certify that under requirements of P.A. 74, Michigan P.A. of 1970, the corner points mentioned in lines 1 and 2 above were in conformance with regulations and rules therefore as required in the current manual of survey instructions of the United States Department of the Interior, Bureau of Land Management or by a decree of a Court of Law and/or that the corner points mentioned in lines 3, 4 and 5 above were in conformance with the rules of the Michigan Board of Land Surveyors or by a Decree of a Court of Law; established, re-established, monumented, re-monumented, recovered, found as expressed below:

NOTE: Not more than 4 corners, all in the same town and range, may be recorded on this certificate.

A. Description of original monument and accessories and/or subsequent restoration:

K - 13 GLO Notes
Set Post Corner: Birch 11 N 28 W 25, Birch 18 N 73½ E 32
Act 74 Form NONE
Act 132 Form Liber 4 Page 133
Unrecorded Surveys Dated 12-23-92
Road Comm NONE
Drain Comm NONE

B. Description of corner evidence found and/or method applied in restoring or reestablishing corner:

K - 13
SE Cor Section 35 T10N-R14E
Found 1/2" Iron Bar
West 1.98 to a 1/2" Iron Bar in the Road Bed
N45°W 59.08 to a nail in a Power Pole
N40°W 34.73 to a Stop Sign
N45°E 133.1 to a nail in a Power Pole
S30°E 34.25 to a stop sign post

Approved Peer Board Meeting
Dec 16, 1994 99

C. Description of monument for corner and accessories established to perpetuate locating the position of the corner:

K - 13
SE Cor Section 35 T10N-R14E
Found 1/2" Iron Bar
West 1.98 to a 1/2" Iron Bar in the Road Bed
N45°W 59.08 to a nail in a Power Pole
N40°W 34.73 to a Stop Sign
N45°E 133.1 to a nail in a Power Pole
S30°E 34.25 to a stop sign post

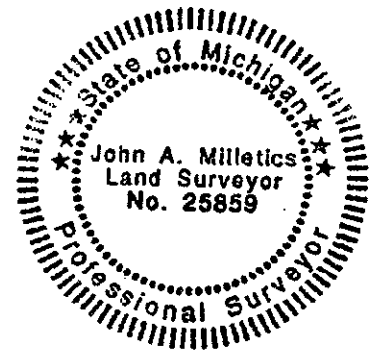

Signed by John A. Milletics Date Dec 12, 1994
Surveyor's Michigan License No. 25859