

RECEIVED FOR RECORD

94 DEC 16 AM 9:40

LIBER NO. 2 PAGE NO. 9
ESTHER LEE
REGISTER OF DEEDS
SANILAC CO., MICHIGAN

REMONUMENTATION

LAND CORNER RECORDATION CERTIFICATE

For corners in Sanilac (County)
REMONUMENTATION

Filing Requirement of Act 74, Mich. P.A. 1970

- APR 10 1995
COMMISSION
- | | | |
|------------------------------------|-------------------------|--------|
| 1. Public Land Survey | T 10 N R 15 E | F - 11 |
| | _____ R _____ | _____ |
| | T _____ R _____ | _____ |
| | T _____ R _____ | _____ |
| 2. Property Controlling in Section | S _____ T _____ R _____ | _____ |
| | S _____ T _____ R _____ | _____ |
| 3. Miscellaneous Property in Sec. | S _____ T _____ R _____ | _____ |
| | S _____ T _____ R _____ | _____ |
4. Lot No. _____, Recorded Plat _____
5. Private Claims _____

Register of Deeds Stamp & File Number

	A	B	C	D	E	F	G	H	I	J	K	L	M
2	6		5		4		3		2		1		
3													
4	7		8		9		10		11		12		
5													
6	18		17		16		15		14		13		
7													
8	19		20		21		22		23		24		
9													
10	30		29		28		27		26		25		
11													
12	31		32		33		34		35		36		
13													

I, John A Milletics, in a field survey on Aug 25, 19 94, do hereby certify that under requirements of P.A. 74, Michigan P.A. of 1970, the corner points mentioned in lines 1 and 2 above were in conformance with regulations and rules therefore as required in the current manual of survey instructions of the United States Department of the Interior, Bureau of Land Management or by a decree of a Court of Law and/or that the corner points mentioned in lines 3, 4 and 5 above were in conformance with the rules of the Michigan Board of Land Surveyors or by a Decree of a Court of Law; established, re-established, monumented, re-monumented, recovered, found as expressed below:

NOTE: Not more than 4 corners, all in the same town and range, may be recorded on this certificate.

A. Description of original monument and accessories and/or subsequent restoration:

F - 11 GLO Notes
Set 1/4 Section Post: Pine 30 S 11 E 30, Hemlock 16 N 37 1/2 W 22 1/2

Act 74 Form NONE
Act 132 Form Liber 3 Page 611, Unrecorded survey Dated 1-11-89, Dated 10-11-85

MDOT Right of Way Book Page 56

Road Comm NONE
Drain Comm NONE

Approved Peer Board Meeting
Dec. 16, 1994 97

B. Description of corner evidence found and/or method applied in restoring or reestablishing corner:

F - 11
S 1/4 Cor Section 28 T10N-R15E
Found Monu Box - Raised Monu Box during Resurfacing

C. Description of monument for corner and accessories established to perpetuate locating the position of the corner:

F - 11
S 1/4 Corner Section 28 T10N-R15E
Found Monu Box
North 75.60 to a nail in a Power Pole
N40°W 107.9 to a nail in a Power Pole
South 50.15 to a nail in a Power Pole
N30°E 83.00 to the SE Cor of a Large Elec Box
Monu Box exist on Road Centerline

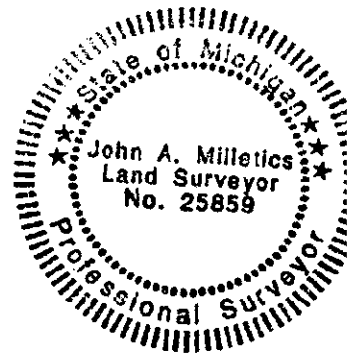

Signed by [Signature] Date Dec 10, 1994

Surveyor's Michigan License No. 25859