

RECEIVED FOR RECORD

94 DEC 16 AM 9:41

REMONUMENTATION SURVEY & LAND CORNER RECORDATION CERTIFICATE  
For corners REMONUMENTATION Filing Requirement of Act 74, Mich. P.A. 1970

LIBER NO. 2 PAGE NO. 10  
ESTHER LEE  
REGISTER OF DEEDS  
SANILAC CO., MICHIGAN

Sanilac (County) APR 10 1995 Located In: Corner Code #

1. Public Land Survey T 10N R 15E G - 11  
T R  
T R  
T R

2. Property Controlling S T R  
in Section S T R

3. Miscellaneous S T R  
Property in Sec. S T R

4. Lot No. \_\_\_\_\_, Recorded Plat \_\_\_\_\_

5. Private Claims \_\_\_\_\_

Register of Deeds Stamp & File Number

I, John A Milletics, in a field survey on Aug 25, 19 94, do hereby certify that under requirements of P.A. 74, Michigan P.A. of 1970, the corner points mentioned in lines 1 and 2 above were in conformance with regulations and rules therefore as required in the current manual of survey instructions of the United States Department of the Interior, Bureau of Land Management or by a decree of a Court of Law and/or that the corner points mentioned in lines 3, 4 and 5 above were in conformance with the rules of the Michigan Board of Land Surveyors or by a Decree of a Court of Law; established, re-established, monumented, re-monumented, recovered, found as expressed below:

NOTE: Not more than 4 corners, all in the same town and range, may be recorded on this certificate.

	A	B	C	D	E	F	G	H	I	J	K	L	M
2	6		5		4		3		2		1		
3													
4	7		8		9		10		11		12		
5													
6	18		17		16		15		14		13		
7													
8	19		20		21		22		23		24		
9													
10	30		29		28		27		26		25		
11													
12	31		32		33		34		35		36		
13													

A. Description of original monument and accessories and/or subsequent restoration:

G - 11 GLO Notes  
Set Section Post: Sugar 7 S 84 W 9, Sugar 13 S 85 E 22

Act 74 Form NONE  
Act 132 Form Liber 3 Page 611 Unrecorded survey Dated 1-11-89, Dated 10-11-85

MDOT Right of Way Book Page 56

Approved Peer Board Meeting  
Dec. 16, 1994 *jm*

Road Comm NONE  
Drain Comm NONE

B. Description of corner evidence found and/or method applied in restoring or reestablishing corner:

G - 11  
SE Corner Section 28 T10N-R15E  
Found Monu Box - Raised Monu Box during Resurfacing

C. Description of monument for corner and accessories established to perpetuate locating the position of the corner:

G - 11  
SE Cor Section 28 T10N-R15E  
Found Monu Box  
N70°E 84.60 to a nail in a 48" Maple  
N45°W 52.75 to a gas riser pipe  
S45°W 89.40 to the NE Cor of a Building  
S30°E 49.35 to a road sign  
Monu Box is 1.8 north of Road Centerline

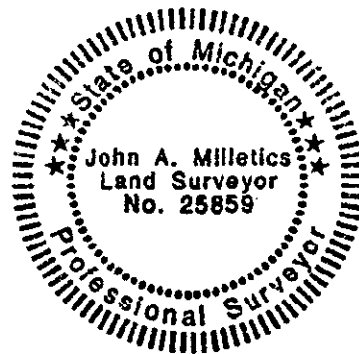

Signed by *John A Milletics*  
Surveyor's Michigan License No. 25859

Date Dec 10, 1994