

SURVEY & REMONUMENTATION

LAND CORNER RECORDATION CERTIFICATE  
Filing Requirement of Act 74, Mich. P.A. 1970

94 DEC 16 AM 9:41

For corners in Sanilac (County) APR 10 1995

LIBER NO. 2 PAGE NO. 11  
ESTHER LEE  
REGISTER OF DEEDS  
SANILAC CO., MICHIGAN

	Located In:	Corner Code #
1. Public Land Survey	T 10N R 15E	H - 11
	T R	
	T R	
	T R	
	T R	
2. Property Controlling in Section	S T R	
	S T R	
3. Miscellaneous Property in Sec.	S T R	
	S T R	
4. Lot No. _____, Recorded Plat _____		
5. Private Claims _____		

Register of Deeds Stamp & File Number

I, John A Milletics, in a field survey on Aug 25, 19 94, do hereby certify that under requirements of P.A. 74, Michigan P.A. of 1970, the corner points mentioned in lines 1 and 2 above were in conformance with regulations and rules therefore as required in the current manual of survey instructions of the United States Department of the Interior, Bureau of Land Management or by a decree of a Court of Law and/or that the corner points mentioned in lines 3, 4 and 5 above were in conformance with the rules of the Michigan Board of Land Surveyors or by a Decree of a Court of Law; established, re-established, monumented, re-monumented, recovered, found as expressed below:

**NOTE: Not more than 4 corners, all in the same town and range, may be recorded on this certificate.**

	A	B	C	D	E	F	G	H	I	J	K	L	M
2	6		5		4		3		2		1		
3													
4	7		8		9		10		11		12		
5													
6	18		17		16		15		14		13		
7													
8	19		20		21		22		23		24		
9													
10	30		29		28		27		26		25		
11													
12	31		32		33		34		35		36		
13													

A. Description of original monument and accessories and/or subsequent restoration:

H - 11 GLO Notes  
Set 1/4 Section Post: Maple 16 S 13 1/2 E 27, Sugar 10 North 56  
Act 74 Form NONE  
Act 132 Form Liber 4 Page 215, Liber 3 Page 50, Approved Peer Board Meeting  
Unrecorded Surveys Dated 9-2-83, Dated 8-7-91 Dec. 16, 1994

B. Description of corner evidence found and/or method applied in restoring or reestablishing corner:

H - 11  
S 1/4 Cor Section 27 T10N-R15E  
Found Monu Box - Raised Monu Box during Resurfacing

C. Description of monument for corner and accessories established to perpetuate locating the position of the corner:

H - 11  
S 1/4 Cor Section 27 T10N-R15E  
Found Monu Box  
North 75.30 to a nail in a Power Pole  
East 2633.20 to a Monu Box (Being the SE Cor Section 27)  
West 2627.08 to a Monu Box (Being the SW Cor Section 27)  
Monu Box is on existing Centerline

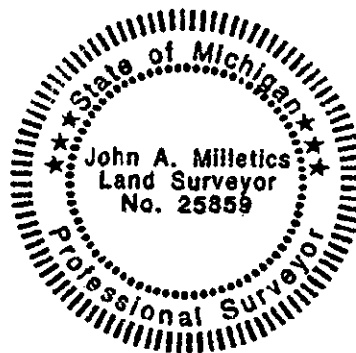

Signed by [Signature] Date Dec 11, 1994  
Surveyor's Michigan License No. 25859