

FEB 22 1996

LAND CORNER RECORDATION CERTIFICATE
Filing Requirement of Act 74, Mich. P.A. 1970

95 DEC -6 PM 2:49

For corners in
Sanilac
(County)
COMMISSION

LIBER NO. 2 PAGE NO. 74
ESTHER LEE
REGISTER OF DEEDS
SANILAC CO. MICHIGAN

	Located In:	Corner Code #
1. Public Land Survey	T <u>10N</u> R <u>15E</u>	<u>L - 5</u>
	T _____ R _____	_____
	T _____ R _____	_____
	T _____ R _____	_____
2. Property Controlling in Section	S _____ T _____ R _____	_____
	S _____ T _____ R _____	_____
3. Miscellaneous Property in Sec.	S _____ T _____ R _____	_____
	S _____ T _____ R _____	_____

Register of Deeds Stamp & File Number

4. Lot No. _____, Recorded Plat _____
5. Private Claims _____

	A	B	C	D	E	F	G	H	I	J	K	L
2	6	5	4	3	2	1						
3												
4	7	8	9	10	11	12						
5												
6	18	17	16	15	14	13						
7												
8	19	20	21	22	23	24						
9												
10	30	29	28	27	26	25						
11												
12	31	32	33	34	35	36						
13												

I, John A Milletics, in a field survey on Oct 6, 1995, do hereby certify that under requirements of P.A. 74, Michigan P.A. of 1970, the corner points mentioned in lines 1 and 2 above were in conformance with regulations and rules therefore as required in the current manual of survey instructions of the United States Department of the Interior, Bureau of Land Management or by a decree of a Court of Law and/or that the corner points mentioned in lines 3, 4 and 5 above were in conformance with the rules of the Michigan Board of Land Surveyors or by a Decree of a Court of Law; established, re-established, monumented, re-monumented, recovered, found as expressed below:

NOTE: Not more than 4 corners, all in the same town and range, may be recorded on this certificate.

A. Description of original monument and accessories and/or subsequent restoration:
L - 5
GLO Notes
Set 1/4 Post at 40.13
Sugar 10 N35E 16
Hemlock 5 S23W 26
Act 74 None
Act 132 Liber 3 Page 96
Old Survey Liber Page 420 Nov 1893

B. Description of corner evidence found and/or method applied in restoring or reestablishing corner:
L - 5
S 1/4 Cor Section 12 T10N-R15E
Found 1" Pipe in gravel road bed

Approved Peer Board Meeting
Dec 6, 1995 JM

C. Description of monument for corner and accessories established to perpetuate locating the position of the corner:
L - 5
S 1/4 Cor Section 12 T10N-R15E
1" Pipe in gravel road bed
South 57.7 to NW Cor of Bell Box
N45W 42.45 to a nail in a Power Pole
S45W 73.1 to a steel Fence Post
N40W 29.9 to a stop sign

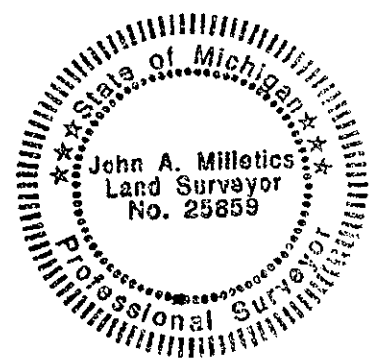

Signed by John A. Milletics Date Nov 23, 1995
Surveyor's Michigan License No. 25859