

SURVEY & REMONUMENTATION

SEP 17 1999

LIBER

2 PAGE 289

RECEIVED FOR RECORD

1999 REMONUMENTATION PROGRAM
LAND CORNER RECORDATION CERTIFICATE
 Filing Requirement of Act 74, Mich. P.A. 1970.

99 AUG -2 AM 9:09

LIBER NO. 2 PAGE NO. 289
 MICHELE VANNORMAN
 REGISTER OF DEEDS
 SANILAC CO., MICHIGAN

SECTION

For corners in

SANILAC

(County)

Located In:

Corner Code #

- | | | | |
|------------------------------------|------|-----------------------------|------------|
| 1. Public Land Survey | | T <u>11</u> N <u>R 12</u> E | <u>A-9</u> |
| | | T___R___ | _____ |
| | | T___R___ | _____ |
| | | T___R___ | _____ |
| 2. Property Controlling in Section | S___ | T___R___ | _____ |
| | S___ | T___R___ | _____ |
| 3. Miscellaneous Property in Sec. | S___ | T___R___ | _____ |
| | S___ | T___R___ | _____ |

Register of Deeds Stamp & File Number

4. Lot No. _____, Recorded Plat _____
 5. Private Claims _____

I, John A. Millettics, in a field survey on April 1, 19 99 do hereby state that under requirements of P.A. 74, Michigan P.A. of 1970, the corner points mentioned in lines 1 and 2 above were in conformance with regulations and rules therefore as required in the current manual of survey instructions of the United States Department of the Interior, Bureau of Land Management or by a decree of a Court of Law and/or that the corner points mentioned in lines 3, 4 and 5 above were in conformance with the rules of the Michigan Board of Land Surveyors or by a Decree of a Court of Law; established, re-established, monumented, recovered, found as expressed below:

NOTE: Not more than 2 corners, all in the same town and range, may be recorded on this certificate.

	A	B	C	D	E	F	G	H	I	J	K	L	M
1													
2	6		5		4		3		2		1		
3													
4	7		8		9		10		11		12		
5													
6	18		17		16		15		14		13		
7													
8	19		20		21		22		23		24		
9													
10	30		29		28		27		26		25		
11													
12	31		32		33		34		35		36		
13													

A. Description of original monument and accessories and/or subsequent restoration:

1834 (Gov't. Land Office Notes) Harvey Parke, D.S. -Set post Cor. Sections 24,25-B. Ash 10
 S11W 41; Sugar 9 N34W 40
 No record of subsequent restoration

B. Description of corner evidence found and/or method applied in restoring or reestablishing corner:

A - 9
 SW Corner Section 19 R11N-R12E
 Found Standard Concrete Monument with Brass Cap
 South 2648.18 feet to the W 1/4 Corner
 North 2650.94 feet to the W 1/4 Corner
 Accepted as best evidence

APPROVED PEER BOARD MEETING
 July 20, 1999

[Signature]

C. Description of monument for corner and accessories established to perpetuate locating the position of the corner:

Found Standard Concrete Monument W/2" Brass Cap
 N35°E, 54.17' T.C. Remon. tag in SE face of 6" Ash
 S35°E, 63.63' T.C. Remon. tag over found nail in West face of power pole
 S45°W, 35.99' Set 5/8" diameter rerod
 NO4°W, 41.30' T.C. Remon. tag over found nail in East face of telephone pole

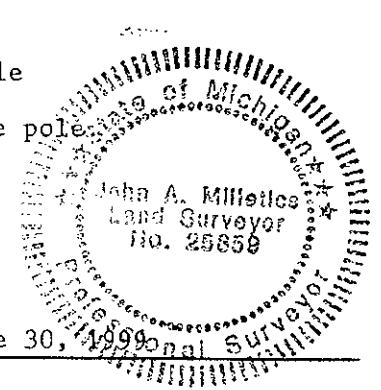

Signed by *John A. Millettics*
 Surveyor's Michigan License No. 25859

Date June 30, 1999