

NOV 21 1997

COMMISSION

REMONUMENTATION  
LAND CORNER RECORDATION CERTIFICATE  
Filing Requirement of Act 74, Mich. P.A. 1970

RECEIVED FOR RECORD  
97 SEP -9 AM 8:57  
LIBER NO. 2 PAGE NO. 132  
ESTHER LEE  
REGISTER OF DEEDS  
SANILAC CO. MICHIGAN

For corners in

Sanilac (County)	Located In:	Corner Code #
1. Public Land Survey	T11NR13E	F - 13
	T R	
	T R	
	T R	
2. Property Controlling in Section	S T R	Seg. 2
	S T R	
3. Miscellaneous Property in Sec.	S T R	
	S T R	

Register of Deeds Stamp & File Number

4. Lot No. \_\_\_\_\_, Recorded Plat \_\_\_\_\_  
5. Private Claims \_\_\_\_\_

I, John A Milletics, in a field survey on June 21, 1997 do hereby state that under requirements of P.A. 74, Michigan P.A. of 1970, the corner points mentioned in lines 1 and 2 above were in conformance with regulations and rules therefore as required in the current manual of survey instructions of the United States Department of the Interior, Bureau of Land Management or by a decree of a Court of Law and/or that the corner points mentioned in lines 3, 4 and 5 above were in conformance with the rules of the Michigan Board of Land Surveyors or by a Decree of a Court of Law; established, re-established, monumented, recovered, found as expressed below:

NOTE: Not more than 2 corners, all in the same town and range, may be recorded on this certificate.

	A	B	C	D	E	F	G	H	I	J	K	L	M
1													
2	6			5		4		3		2		1	
3													
4	7			8		9		10		11		12	
5													
6	18			17		16		15		14		13	
7													
8	19			20		21		22		23		24	
9													
10	30			29		28		27		26		25	
11													
12	31			32		33		34		35		36	
13													

A. Description of original monument and accessories and/or subsequent restoration:

F - 13  
GLO Notes  
Cedar 12 N61°W 11  
Birch 10 N81°E 37½

APPROVED PEER BOARD MEETING  
Aug 18, 1997 JM

B. Description of corner evidence found and/or method applied in restoring or reestablishing corner:

F - 13  
S 1/4 Cor Section 33 T11N-R13E  
Found Monu Box in Place - removed by the Sanilac County Road Comm. during reconstruction of the Road - REPLACED using Act 74 as recorded in Liber 1 Page 410

C. Description of monument for corner and accessories established to perpetuate locating the position of the corner:

F - 13  
S 1/4 Corner Section 33 T11N-R13E  
MONU BOX with iron and cap  
N10°W 32.30 feet to the North end of a CMP  
S10°W 31.90 feet to the South end of a CMP  
East 2653.50 feet to the SE Corner Section 33 (MONU BOX)  
West 34.45 feet to a MONU Box  
West 2653.64 feet to the SW Corner Section 33 (MONU BOX)

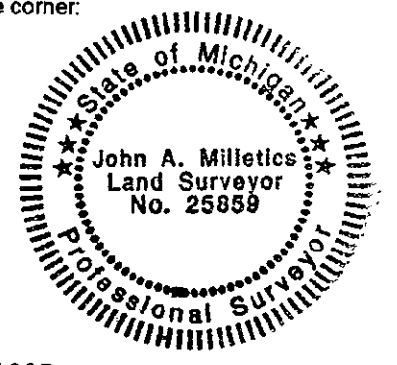

Signed by [Signature]  
Surveyor's Michigan License No. 25859

Date Aug 11, 1997