

REMONUMENTATION

NOV 21 1997

COMMISSION

LIBER

2 PAGE 135

REMONUMENTATION
LAND CORNER RECORDATION CERTIFICATE
Filing Requirement of Act 74, Mich. P.A. 1970

RECEIVED FOR RECORD

97 SEP -9 AM 8:57

LIBER NO. 2 PAGE NO. 135
ESTHER LEE
REGISTER OF DEEDS
SANILAC CO., MICHIGAN

For corners in

Sanilac (County)	Located In:	Corner Code #
1. Public Land Survey	T 11N R 13E	I - 13
	T R	
	T R	
	T R	
	T R	
2. Property Controlling in Section	S T R	Seg 2
	S T R	
3. Miscellaneous Property in Sec.	S T R	
	S T R	

Register of Deeds Stamp & File Number

4. Lot No. _____, Recorded Plat _____
5. Private Claims _____

I, John A Milletics, in a field survey on Aug 11, 1997 do hereby state that under requirements of P.A. 74, Michigan P.A. of 1970, the corner points mentioned in lines 1 and 2 above were in conformance with regulations and rules therefore as required in the current manual of survey instructions of the United States Department of the Interior, Bureau of Land Management or by a decree of a Court of Law and/or that the corner points mentioned in lines 3, 4 and 5 above were in conformance with the rules of the Michigan Board of Land Surveyors or by a Decree of a Court of Law; established, re-established, monumented, recovered, found as expressed below:

NOTE: Not more than 2 corners, all in the same town and range, may be recorded on this certificate.

	A	B	C	D	E	F	G	H	I	J	K	L	M
1													
2	6		5		4		3		2		1		
3													
4	7		8		9		10		11		12		
5													
6	18		17		16		15		14		13		
7													
8	19		20		21		22		23		24		
9													
10	30		29		28		27		26		25		
11													
12	31		32		33		34		35		36		
13													

A. Description of original monument and accessories and/or subsequent restoration:

I - 13
GLO Notes
Birch 16 N29W 57
Birch 7 N85E 33½

APPROVED PEER BOARD MEETING
Aug 18, 1997 gm

B. Description of corner evidence found and/or method applied in restoring or reestablishing corner:

I - 13
SW Cor Section 35 T11N-R13E
Found Monu Box in Place - removed by the Sanilac County Road Comm. during reconstruction of Road - REPLACED using Act 74 as recorded in Liber 1 Page 412

C. Description of monument for corner and accessories established to perpetuate locating the position of the corner:

I - 13
SW Cor Section 35 T11N-R13E
MONU BOX with iron and cap
South 18.62 feet to the West leg of a Road Sign
S05°E 18.72 feet to the East leg of a Road Sign
N75°E 64.70 feet to a Tele Box
N50°E 64.62 feet to a Riser Box
S45°W 71.02 feet to a Stop Sign
East 2659.82 feet to the S 1/4 Cor Section 35

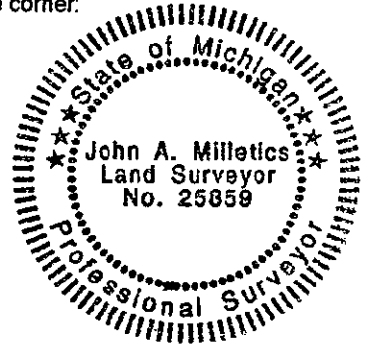

Signed by [Signature]
Surveyor's Michigan License No. 25859

Date Aug 11, 1997